

TVSS V

TOYOTA VEHICLE SECURITY SYSTEM

ELECTRICAL WIRING DIAGRAM

Corolla

PART NUMBER

MAIN KIT (Only for Belgium)	08585-12980
MAIN KIT (Other countries)	08585-12990
FITTING KIT	08586-1E831
GLASS BREAKAGE SENSOR KIT	08192-13820
RADAR SENSOR	08192-1E890
SIREN KIT	08192-13810
ENGINE COMPARTMENT FITTING KIT	08586-1E840 ⁽¹⁾ 08586-1E842 ⁽²⁾
HOOD SWITCH BRACKET	PZ425-E9130-01

⁽¹⁾ FOR PETROL AND DIESEL ENGINES - ALL MODELS, EXCEPT
DIESEL ENGINE - **E12*L-****X*

⁽²⁾ FOR DIESEL ENGINE - **E12*L-****X* MODELS ONLY

FOR ****E12*L-A + **E12*L-D**

LHD



PRECAUTIONS



PLEASE READ THOROUGHLY THESE PRECAUTIONS BEFORE THE INSTALLATION

- Be sure to disconnect the negative (-) lead from the battery terminals.

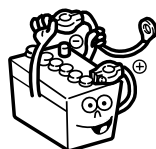

- Confirm that lamps, horn, wiper and other car accessories operate normally.

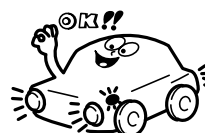

- Do not pinch the rear wiring or harness in the tightened part.



- Protect your car using wing covers, seat and so on.

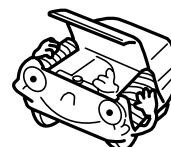

- When passing the wires through the bulkhead or other panels, use a grommet to ensure waterproofing.
- Protect the wiring using tape when it is passed through a hole.

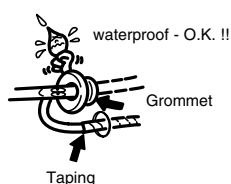

- Use the correct tool when tightening bolts or nuts.

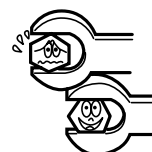

- When disconnecting the connectors, be sure to grip the connector body. Do not tug on the wiring.

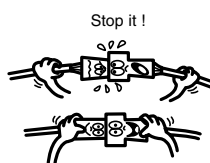

- Before drilling a hole, check that the rear of the mounting wall is clear.

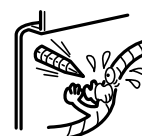

- Do not forcibly pull any car wiring harness. Rough tugging may result in opened connections, or a broken wire or harness.

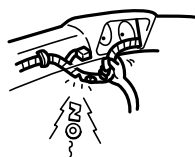

- Be sure to firmly tighten connectors and terminals.

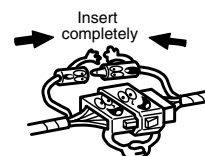

- Before connecting the power wiring to the battery, check the wiring connections, harness, etc. to see that they are properly secured.

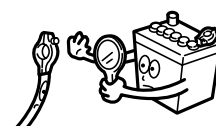

- Check body and trim near area of installation to be certain no dirt or scratches resulted from the installation.

TABLE OF CONTENTS

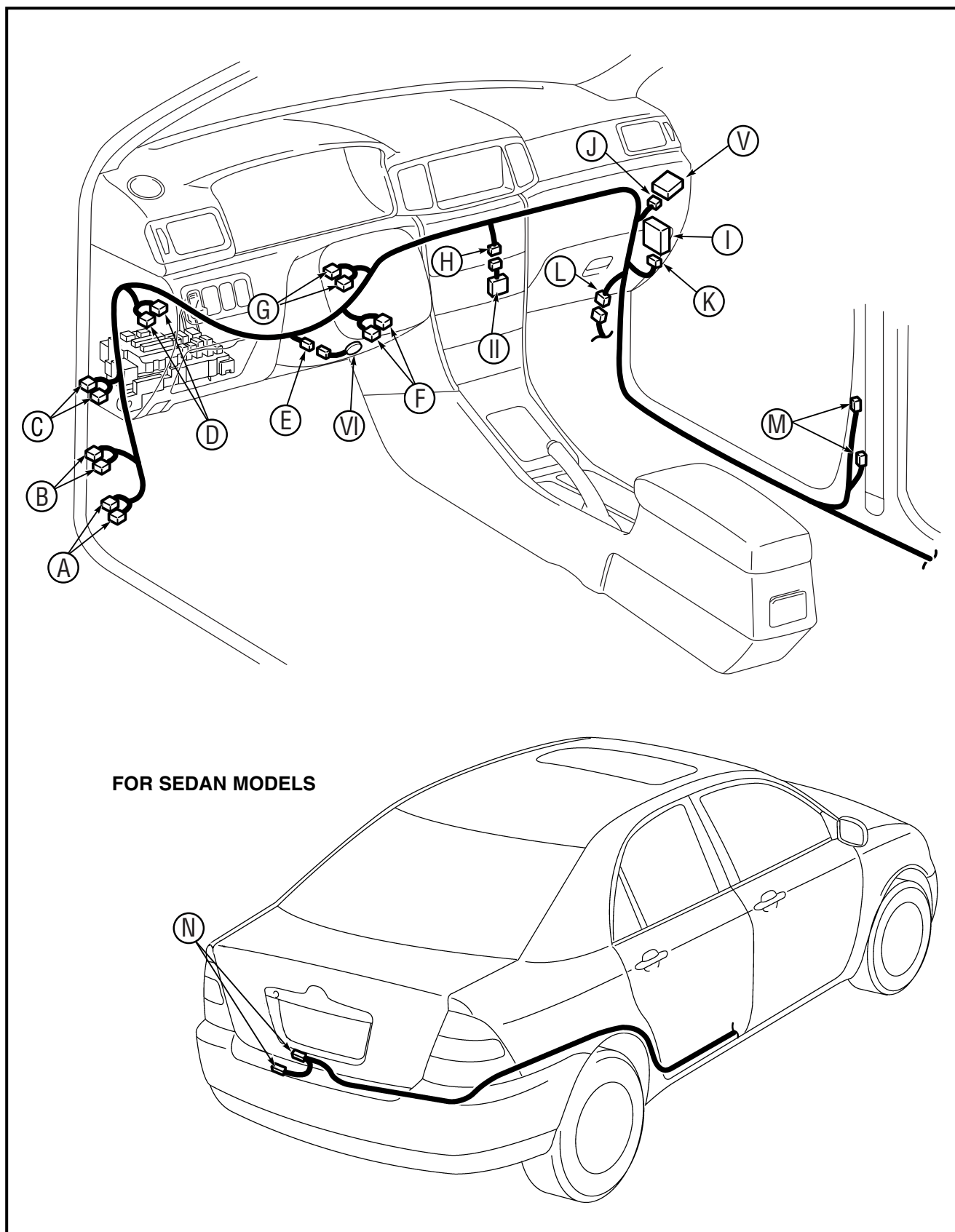

Precautions.....	2
System Layout and Wire Harness Outline (Main).....	4
System Layout and Wire Harness Outline (Engine).....	7
Electrical Wiring Diagram of TVSS V for Corolla LHD.....	8
Connector Arrangement of the TVSS Fitting Kit	10

SYSTEM LAYOUT AND WIRE HARNESS OUTLINE (MAIN) (E12*L-A)** 

SYSTEM LAYOUT AND WIRE HARNESS OUTLINE (MAIN) (**E12*L-D) 

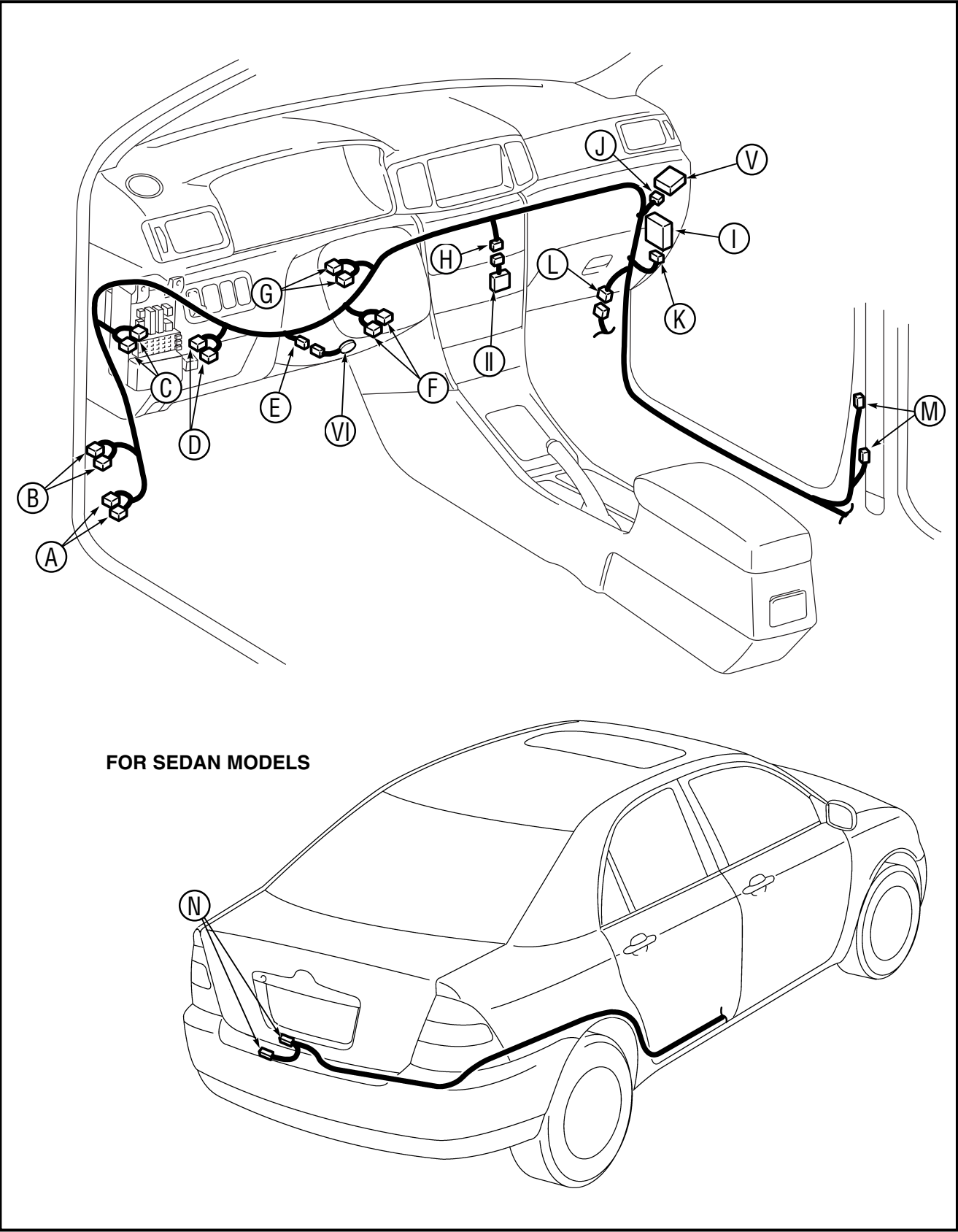

Ⓐ	Driver's side connector block (10P female and male white)
Ⓑ	Driver's side connector block (12P female and male white)
Ⓒ	Turn signal flasher relay connector (8P female and male black)
Ⓓ	Driver's side J/B connector (6P female and male white)
Ⓔ	Microphone connector (2P male white)
Ⓕ	Key unlock warning connector (2P female and male black)
Ⓖ	Horn connector (12P female and male white)
Ⓗ	Radar sensor connector (4P female white)
Ⓙ	Glass breakage control unit connector (8P female white)
Ⓚ	TVSS ECU connector (40P female white)
Ⓛ	Pre-wired connector (10P male white)
Ⓜ	Courtesy switch connector (1P female and male white)
Ⓝ	Luggage compartment switch connector (1P female and male white, for sedan model only)
Ⓛ	TVSS ECU
Ⓜ	Radar sensor
Ⓥ	Glass breakage control unit
Ⓦ	Microphone

SYSTEM LAYOUT AND WIRE HARNESS OUTLINE (ENGINE)



PETROL ENGINE & DIESEL ENGINE
(EXCEPT DIESEL ENGINE - **E12*L-***X* MODELS)

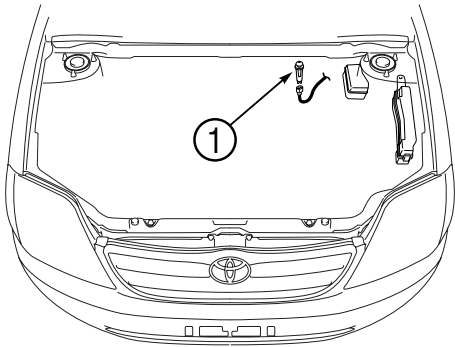

LIMOUSINE / SEDAN

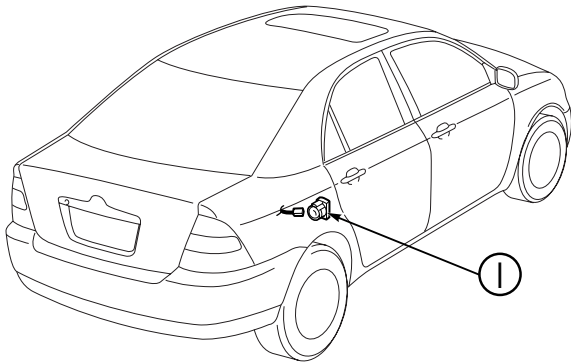

5 DOOR HATCH BACK

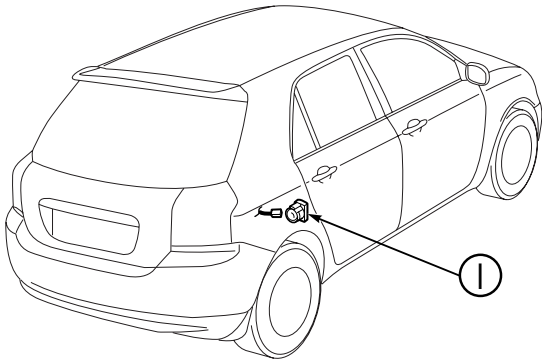

DIESEL ENGINE
(FOR **E12*L-***X* MODELS ONLY)

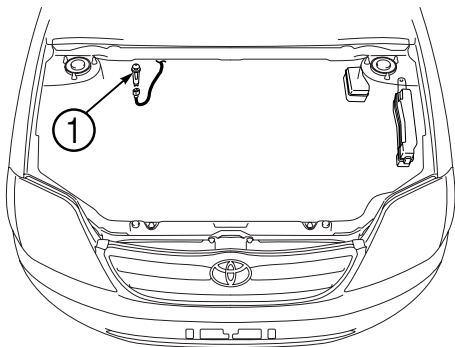

KOMBI / WAGON

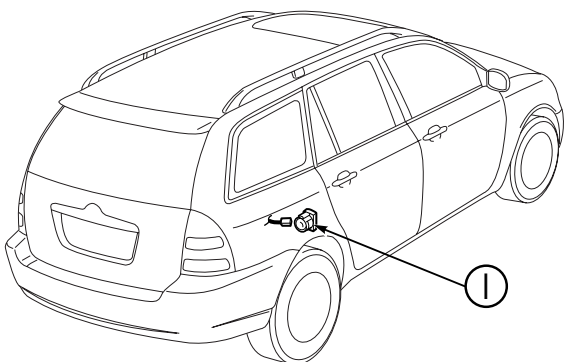

3 DOOR HATCH BACK

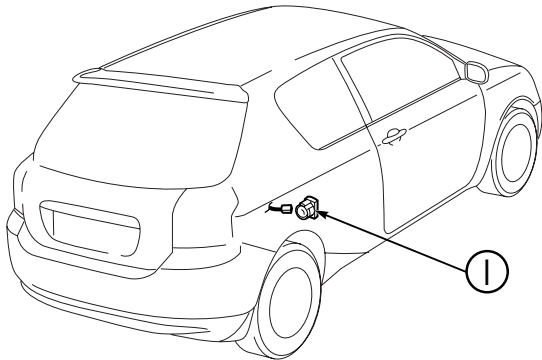

①	Hood switch
①	Siren

ELECTRICAL WIRING DIAGRAM OF TVSS V FOR COROLLA LHD

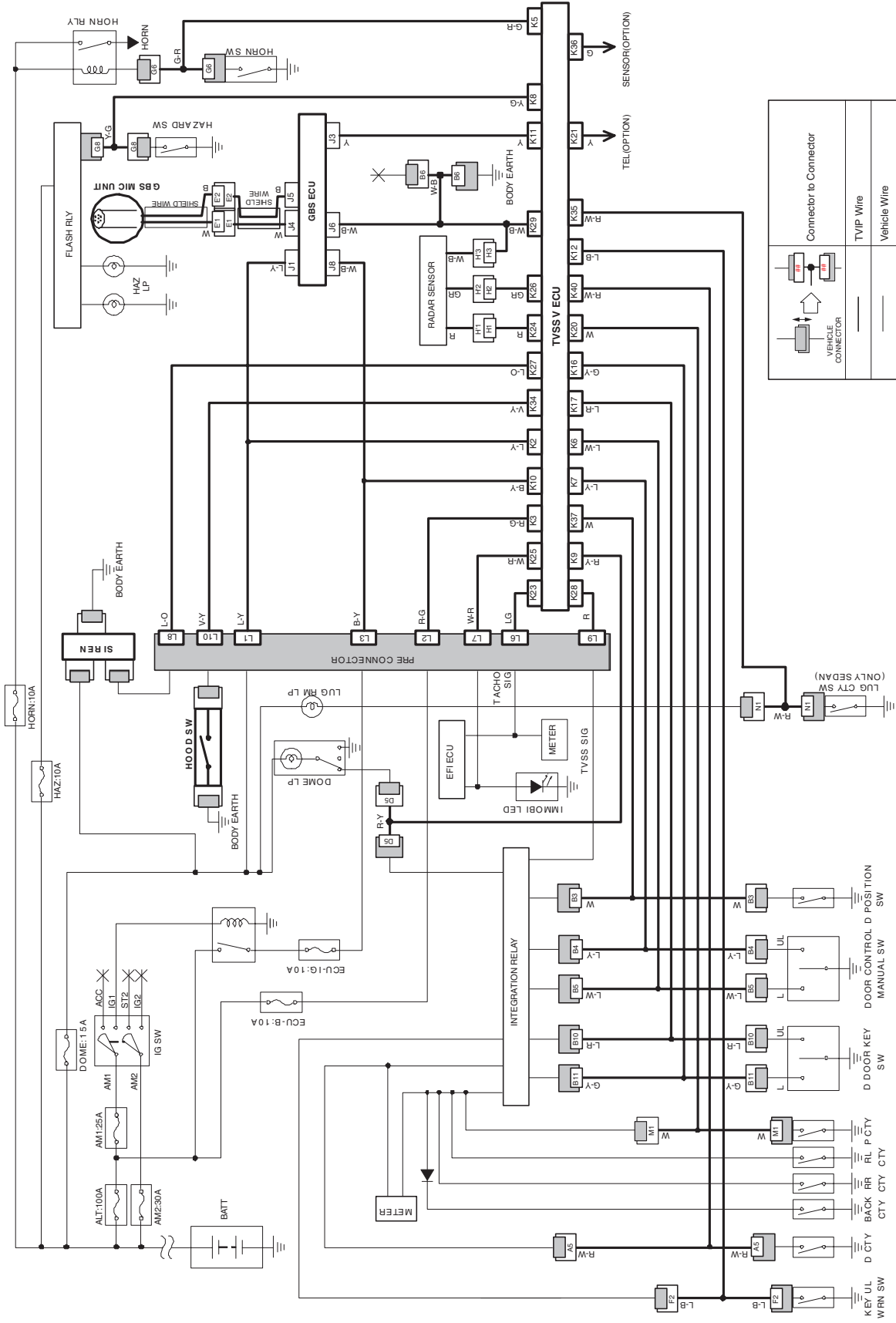

CONNECTOR ARRANGEMENT OF THE TVSS FITTING KIT (PIN VIEW) 

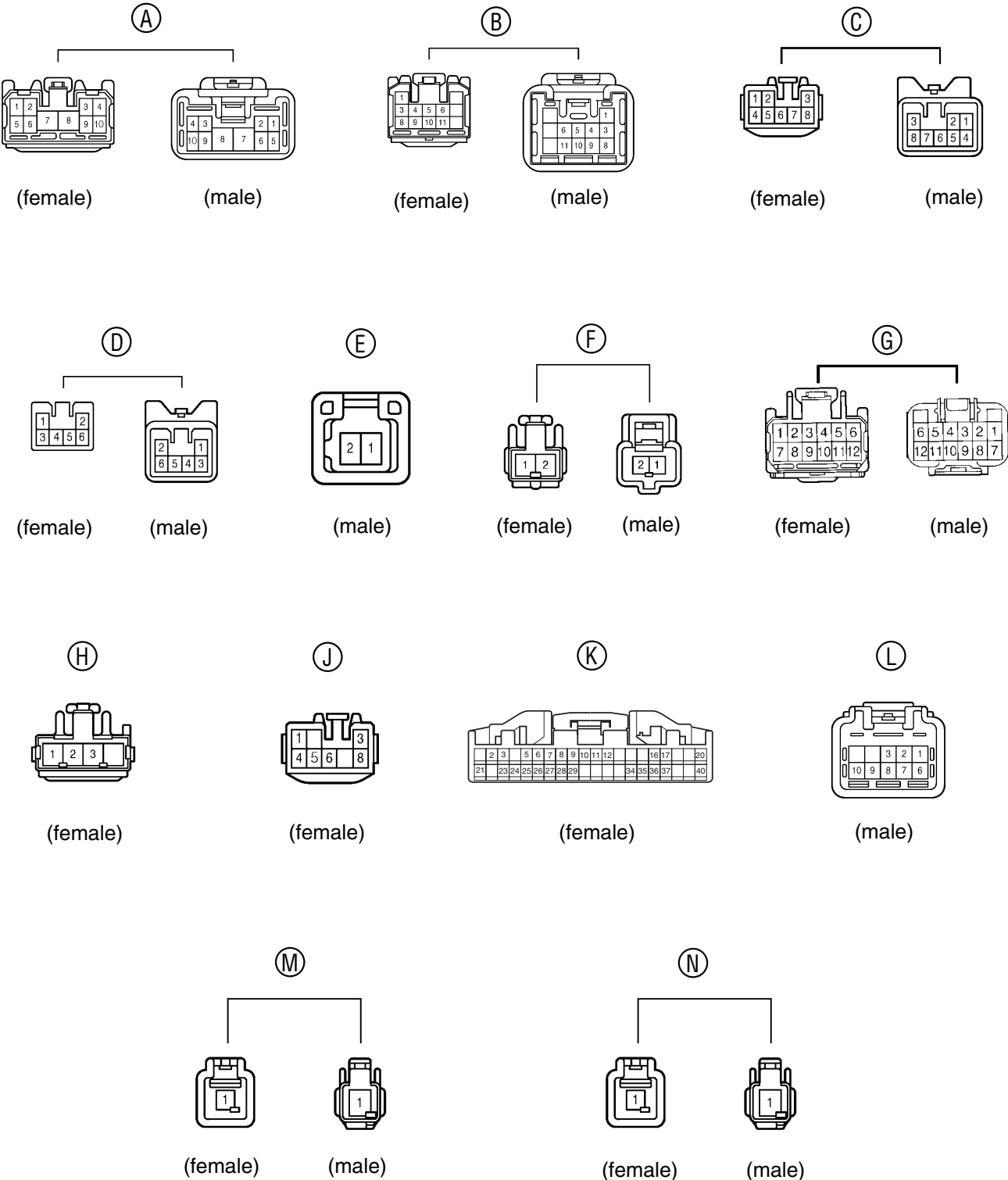

(FOR SEDAN MODELS)

