



Toyota Genuine Audio

INSTALLATION INSTRUCTIONS

FOR

PRELIMINARY



Avensis (RHD)

****T22*R - MMC (07/00)**

PRELIMINARY

TABLE OF CONTENTS 

1. Audio Application Chart 4

2. Required Parts 8

3. Combo Installation 9

4. 6 Disc CD Changer Installation in glove box 11

5. CD Changer Installation 18

6. MD Changer Installation 28

7. Tweeter Installation 32

 - Tweeters in mirror cover

PRELIMINARY

| COMBINATION | | HEAD UNIT | | + ADD-ON UNIT(S) | | REQUIRED ADDITIONAL PARTS |
|-------------|----------------------------------------------------------|---------------------------------|-----------------------------------------|---------------------------------|-----------------------------------------------------------------------------------|--------------------------------------------------------------------------------|
| | | CD-Changer TM0461 (08601-00892) | In-Dash CD-Changer TM0561 (08601-00893) | MD-Changer TM0660 (08601-00900) | Navigation System TNS500 (08545-00803) (Can not be applied for Avensis T22 - MMC) | |
| 0 | NO radio (dummy unit) | | | | | 08605-08510 |
| 1 | Radio/Cassette (only) | | T8401 (08600-05810) | | | - |
| 2 | CD-Tuner (only) | | W53804 (08600-05820) | | | - |
| 3 | Radio/Cassette + Cassette storage | | MOP-unit T8401 (08600-05810) | | | F/K (08695-05800) F/K (08695-05800) |
| 4 | Radio/Cassette + CD-Deck | | MOP-unit T8401 (08600-05810) | ● (1) ● (1) | | F/K (08695-05800) F/K (08695-05800) |
| 5 | Radio/Cassette + CD-Changer | | MOP-unit T8401 (08600-05810) | ● (1) ● (1) | | Wire (08695-00260) Wire (08695-00260) |
| 6 | Radio/Cassette + In dash CD-Changer | | MOP-unit T8401 (08600-05810) | ● (1) ● (1) | | F/K (08695-05800) F/K (08695-05800) |
| 7 | Radio/Cassette + MD-Changer | | MOP-unit T8401 (08600-05810) | ● (1) ● (1) | ● (1) ● (1) | - - |
| 8 | Radio/Cassette + CD-Deck + CD-Changer | | MOP-unit T8401 (08600-05810) | ● (1) ● (1) | ● (1) ● (1) | F/K (08695-05800) + W/H (08695-00260) F/K (08695-05800) + W/H (08695-00260) |
| 9 | Radio/Cassette + CD-Deck + MD-Changer | | MOP-unit T8401 (08600-05810) | ● (1) ● (1) | ● (1) ● (1) | F/K (08695-05800) F/K (08695-05800) |
| 10 | Radio/Cassette + CD-Changer CD/Cass-storage | | MOP-unit T8401 (08600-05810) | ● (1) ● (1) | ● (1) ● (1) | F/K (08695-05800) F/K (08695-05800) |
| 11 | Radio/Cassette + CD-Changer + MD-Changer | | MOP-unit T8401 (08600-05810) | ● (1) ● (1) | ● (1) ● (1) | Wire (08695-00260) Wire (08695-00260) |
| 12 | Radio/Cassette + CD-Changer + MD-Changer+CD/Cass-storage | | MOP-unit T8401 (08600-05810) | ● (1) ● (1) | ● (1) ● (1) | F/K (08695-05800) F/K (08695-05800) |
| 13 | Radio/Cassette + In dash CD-Changer + MD-Changer | | MOP-unit T8401 (08600-05810) | ● (1) ● (1) | ● (1) ● (1) | F/K (08695-05800) F/K (08695-05800) |

AUDIO APPLICATION CHART
 TMME-CA Division Dev. Dept. II - October 1st, 2000

Avensis MMC **T22**

(LHD+RHD)

| | | + ADD-ON UNIT(S) | | | | |
|--------------------|---------------------------------------------------------------------------|------------------------------------------------|-------|------------------------------------------------------------------------------------------|----------------|------------------------------------------------------------------------------------------------|
| | | CD-Changer TM0461 (08601-00879) | | MD-Changer TM0660 (08601-00900) | | |
| | | In-Dash CD-Changer TM0561 (08601-00892) | | Navigation System TNS500 (08545-00803) (Can not be applied for Avensis T22 - MMC) | | |
| | | CD-Deck TF0411 (08601-00893) | | Navigation System TNS200 (08545-00802) | | |
| | | Cassette-Deck TM0300 (08690-00824) | | Cassette-Storage PZ437-90342-00 or CD-Storage PZ437-90341-00 | | |
| COMBINATION | HEAD UNIT | | | | | REQUIRED ADDITIONAL PARTS |
| 14 | Radio/Cassette + MD-Changer + Cass-storage | MOP-unit T8401 (08600-05810) | ● | ● | ● (1) ● (1) | F/K (08695-05800) F/K (08695-05800) |
| 15 | Radio/Cassette + TbyT Navigation | MOP-unit T8401 (08600-05810) | ● | ● | ● | F/K (08605-00812) (2) F/K (08605-00812) (2) |
| 16 | Radio/Cassette + CD-Changer + TbyT Navigation | MOP-unit T8401 (08600-05810) | ● | ● | ● | Wire (08695-00260) + F/K (08605-00812) (2) Wire (08695-00260) + F/K (08605-00812) (2) |
| 17 | Radio/Cassette + CD-Deck + TbyT Navigation | MOP-unit T8401 (08600-05810) | ● (1) | ● (1) | ● | F/K (08695-05800) + F/K (08605-00812) (2) F/K (08695-05800) + F/K (08605-00812) (2) |
| 18 | Radio/Cassette + In dash CD-Changer + TbyT Navigation | MOP-unit T8401 (08600-05810) | ● (1) | ● (1) | ● | F/K (08695-05800) + F/K (08605-00812) (2) F/K (08695-05800) + F/K (08605-00812) (2) |
| 19 | Radio/Cassette + Cass-storage + TbyT Navigation | MOP-unit T8401 (08600-05810) | ● | ● | ● (1) ● (1) | F/K (08695-05800) + F/K (08605-00812) (2) F/K (08695-05800) + F/K (08605-00812) (2) |
| 20 | Radio/Cassette + CD-Changer + MD-Changer + TbyT Navigation | MOP-unit T8401 (08600-05810) | ● | ● | ● | Wire (08695-00260) + F/K (08605-00812) (2) Wire (08695-00260) + F/K (08605-00812) (2) |
| 21 | Radio/Cassette + Cass-storage + MD-Changer + TbyT Navigation | MOP-unit T8401 (08600-05810) | ● | ● | ● (1) ● (1) | F/K (08695-05800) + F/K (08605-00812) (2) F/K (08695-05800) + F/K (08605-00812) (2) |
| 22 | Radio/Cassette + MD Changer + TbyT Navigation | MOP-unit T8401 (08600-05810) | ● | ● | ● | F/K (08605-00812) (2) + F/K (08605-00812) (2) F/K (08605-00812) (2) + F/K (08605-00812) (2) |
| 23 | Cassette/Radio + Cassette storage + CD-Changer + TbyT Navigation | MOP-unit T8401 (08600-05810) | ● | ● | ● (1) ● (1) | F/K (08695-05800) + F/K (08605-00812) (2) F/K (08695-05800) + F/K (08605-00812) (2) |
| 24 | Cassette/Radio + CD-Deck + MD-Changer + TbyT Navigation | MOP-unit T8401 (08600-05810) | ● (1) | ● (1) | ● | F/K (08695-05800) + F/K (08605-00812) (2) F/K (08695-05800) + F/K (08605-00812) (2) |
| 25 | Cassette/Radio + In-Dash CD-Changer + MD-Changer + TbyT Navigation | MOP-unit T8401 (08600-05810) | ● (1) | ● (1) | ● | F/K (08695-05800) + F/K (08605-00812) (2) F/K (08695-05800) + F/K (08605-00812) (2) |
| 26 | Cassette/Radio + Cassette Storage + MD-Changer + CD-Changer + TbyT Navig. | MOP-unit T8401 (08600-05810) | ● | ● | ● (1) ● (1) | F/K (08695-05800) + F/K (08605-00812) (2) F/K (08695-05800) + F/K (08605-00812) (2) |

AUDIO APPLICATION CHART
 TMME-CA Division Dev. Dept. II - October 1st, 2000

Avensis MMC **T22**

(LHD+RHD)

| COMBINATION | | HEAD UNIT | + ADD-ON UNIT(S) | | REQUIRED ADDITIONAL PARTS |
|-------------------------------------------------------------------------------------|----------------------------------------------------|----------------------------------|-----------------------------------------|-----------------------------------------------------------------------------------|--------------------------------------------------------------------------------|
| | | | CD-Changer TM0461 (08601-00879) | MD-Changer TM0660 (08601-00900) | |
|  | | | In-Dash CD-Changer TM0561 (08601-00892) | Navigation System TNS500 (08545-00803) (Can not be applied for Avensis T22 - MMC) | |
| | | | CD-Deck TF0411 (08601-00893) | Navigation System TNS200 (08545-00802) | |
| | | | Cassette-Deck TM0300 (08690-00824) | Cassette-Storage PZ437-90342-00 or CD-Storage PZ437-90341-00 | |
| 27 | CD-Tuner + CD-storage | MOP-unit W53804 (08600-05820) | | | F/K (08695-05800) F/K (08695-05800) |
| 28 | CD-Tuner + Cassette-Deck | MOP-unit W53804 (08600-05820) | ● (1) ● (1) | | F/K (08695-05800) F/K (08695-05800) |
| 29 | CD-Tuner + CD-Changer | MOP-unit W53804 (08600-05820) | ● (1) ● (1) | | Wire (08695-00260) Wire (08695-00260) |
| 30 | CD-Tuner + In dash CD-Changer | MOP-unit W53804 (08600-05820) | ● (1) ● (1) | | F/K (08695-05800) F/K (08695-05800) |
| 31 | CD-Tuner + MD-Changer | MOP-unit W53804 (08600-05820) | | | - - |
| 32 | CD-Tuner + Cassette-Deck + CD-Changer | MOP-unit W53804 (08600-05820) | ● (1) ● (1) | | F/K (08695-05800) + W/H (08695-00260) F/K (08695-05800) + W/H (08695-00260) |
| 33 | CD-Tuner + Cassette-Deck + MD-Changer | MOP-unit W53804 (08600-05820) | ● (1) ● (1) | | F/K (08695-05800) F/K (08695-05800) |
| 34 | CD-Tuner + CD-Changer + CD-storage | MOP-unit W53804 (08600-05820) | ● (1) ● (1) | | F/K (08695-05800) F/K (08695-05800) |
| 35 | CD-Tuner + CD-Changer + MD-Changer | MOP-unit W53804 (08600-05820) | ● (1) ● (1) | | Wire (08695-00260) Wire (08695-00260) |
| 36 | CD-Tuner + CD-Changer + MD-Changer + CD-Storage | MOP-unit W53804 (08600-05820) | ● (1) ● (1) | | F/K (08695-05800) F/K (08695-05800) |
| 37 | CD-Tuner + In-Dash CD-Changer + MD-Changer | MOP-unit W53804 (08600-05820) | ● (1) ● (1) | | F/K (08695-05800) F/K (08695-05800) |
| 38 | CD-Tuner + MD-Changer + CD-storage | MOP-unit W53804 (08600-05820) | ● (1) ● (1) | | F/K (08695-05800) F/K (08695-05800) |
| 39 | CD-Tuner + TbyT Navigation | MOP-unit W53804 (08600-05820) | | | F/K (08605-00812) (2) F/K (08605-00812) (2) |

AUDIO APPLICATION CHART
 TMME-CA Division Dev. Dept. II - October 1st, 2000

Avensis MMC **T22**

(LHD+RHD)

| COMBINATION | | + ADD-ON UNIT(S) | | REQUIRED ADDITIONAL PARTS |
|-------------|----------------------------------------------------------------------|----------------------|-------|---------------------------------------------------------------|
| | | HEAD UNIT | | |
| 40 | CD-Tuner + Cassette-Deck + TbyT Navigation | MOP-unit | ● (1) | F/K (08695-05800) + F/K (08605-00812) (2) |
| | | W53804 (08600-05820) | ● (1) | F/K (08695-05800) + F/K (08605-00812) (2) |
| 41 | CD-Tuner + CD-Storage + TbyT Navigation | MOP-unit | ● (1) | F/K (08695-05800) + F/K (08605-00812) (2) |
| | | W53804 (08600-05820) | ● (1) | F/K (08695-05800) + F/K (08605-00812) (2) |
| 42 | CD-Tuner + In dash CD-Changer + TbyT Navigation | MOP-unit | ● (1) | F/K (08695-05800) + F/K (08605-00812) (2) |
| | | W53804 (08600-05820) | ● (1) | F/K (08695-05800) + F/K (08605-00812) (2) |
| 43 | CD-Tuner + CD-Changer + TbyT Navigation | MOP-unit | ● (1) | Wire (08695-00260) + F/K (08605-00812) (2) |
| | | W53804 (08600-05820) | ● (1) | Wire (08695-00260) + F/K (08605-00812) (2) |
| 44 | CD-Tuner + MD-Changer + TbyT Navigation | MOP-unit | ● (1) | Wire (08695-00260) + F/K (08605-00812) (2) |
| | | W53804 (08600-05820) | ● (1) | Wire (08695-00260) + F/K (08605-00812) (2) |
| 45 | CD-Tuner + CD-Changer + MD-Changer + TbyT Navigation | MOP-unit | ● (1) | Wire (08695-00260) + F/K (08605-00812) (2) |
| | | W53804 (08600-05820) | ● (1) | Wire (08695-00260) + F/K (08605-00812) (2) |
| 46 | CD-Tuner + In dash CD-Changer + MD-Changer + TbyT Navigation | MOP-unit | ● (1) | F/K (08695-05800) + F/K (08605-00812) (2) |
| | | W53804 (08600-05820) | ● (1) | F/K (08695-05800) + F/K (08605-00812) (2) |
| 47 | CD-Tuner + Cassette-Deck + CD-Changer + TbyT Navigation | MOP-unit | ● (1) | F/K (08695-05800) + W/H (08695-00260) + F/K (08605-00812) (2) |
| | | W53804 (08600-05820) | ● (1) | F/K (08695-05800) + W/H (08695-00260) + F/K (08605-00812) (2) |
| 48 | CD-Tuner + Cassette-Deck + MD-Changer + TbyT Navigation | MOP-unit | ● (1) | F/K (08695-05800) + F/K (08605-00812) (2) |
| | | W53804 (08600-05820) | ● (1) | F/K (08695-05800) + F/K (08605-00812) (2) |
| 49 | CD-Tuner + CD-Storage + CD-Changer + TbyT Navigation | MOP-unit | ● (1) | F/K (08695-05800) + F/K (08605-00812) (2) |
| | | W53804 (08600-05820) | ● (1) | F/K (08695-05800) + F/K (08605-00812) (2) |
| 50 | CD-Tuner + CD-Storage + MD-Changer + TbyT Navigation | MOP-unit | ● (1) | F/K (08695-05800) + F/K (08605-00812) (2) |
| | | W53804 (08600-05820) | ● (1) | F/K (08695-05800) + F/K (08605-00812) (2) |
| 51 | CD-Tuner + Cassette-Deck + CD-Changer + MD-Changer + TbyT Navigation | MOP-unit | ● (1) | F/K (08695-05800) + W/H (08695-00260) + F/K (08605-00812) (2) |
| | | W53804 (08600-05820) | ● (1) | F/K (08695-05800) + W/H (08695-00260) + F/K (08605-00812) (2) |
| 52 | CD-Tuner + CD-Storage + CD-Changer + MD-Changer + TbyT Navigation | MOP-unit | ● (1) | F/K (08695-05800) + F/K (08605-00812) (2) |
| | | W53804 (08600-05820) | ● (1) | F/K (08695-05800) + F/K (08605-00812) (2) |

08695-05800 = Add-on Mounting Kit (Glove Box) // 08695-00260 = Junction Cord
 (1): Glove Box application
 (2): TNS 200 Mounting Kit for Sedan only

2. REQUIRED PARTS Toyota Logo

JUNCTION CORD 08695-00260

This wire harness splitter is required for certain applications. See Audio Application Chart to find out if this part is needed.

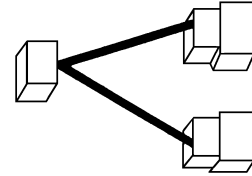

GLOVE BOX MOUNTING KIT 08695-05800

This is only required for applications that are mounted in the glove box. See audio application chart for more information.

| No. | Part name | Quantity |
|-----|----------------------|----------|
| ⑥0 | MOUNTING BRACKET | 2 |
| ⑥1 | FOAM | 1 |
| ⑥2 | PANEL | 1 |
| ⑥3 | TAPPING SCREW | 4 |
| ⑥4 | SQUARE ADHESIVE FELT | 1 |
| ⑥5 | JUNCTION CORD | 1 |

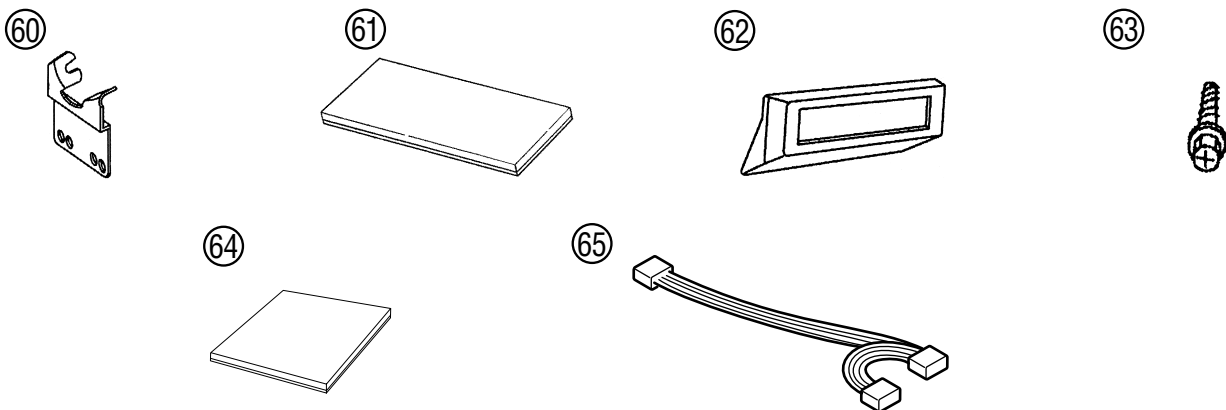

3. COMBO INSTALLATION

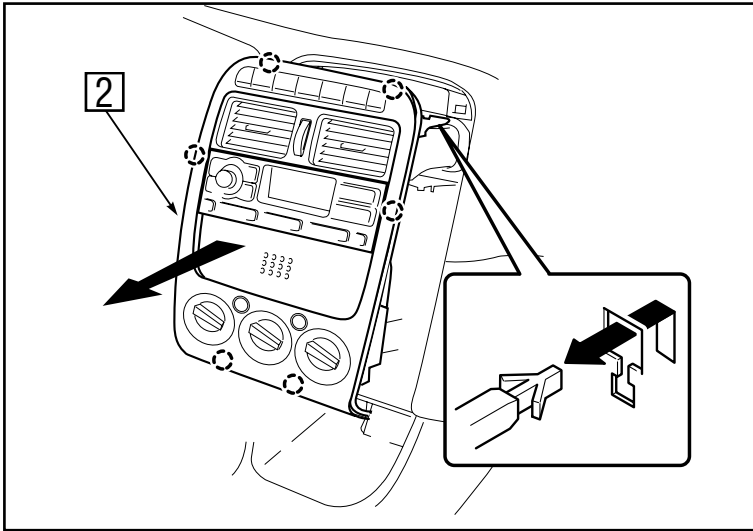

Fig. 1

1. Remove the centre cluster panel **2**.

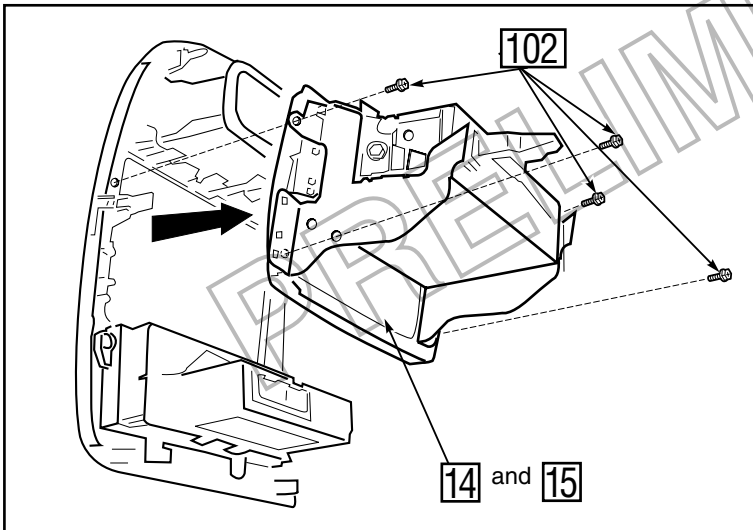

Fig. 2

2. Remove the audio assembly **14** and the cover plate **15**.
102 : Screw (4x)

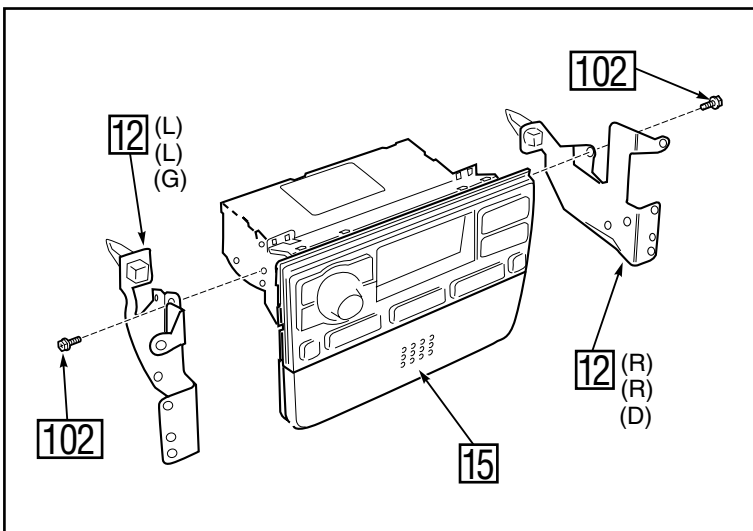

Fig. 3

3. Remove the brackets **12** from the cover plates **15**.
102 : Screw (2x)

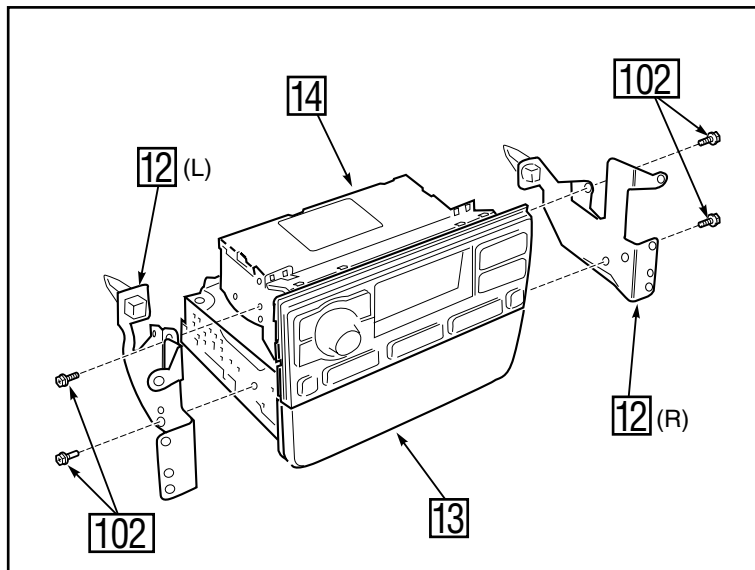

Fig. 4

4. Mount the brackets 12 onto the audio assembly 14 and combo 13.
102 : Screw (4x)

NOTE:
For part number see audio application chart pages 4 to 8.

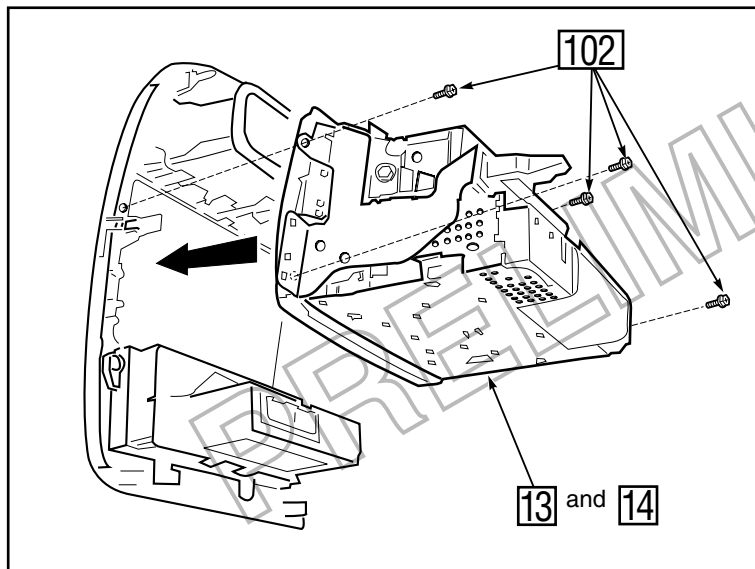

Fig. 5

5. Fit the audio assembly 14 and combo 13.

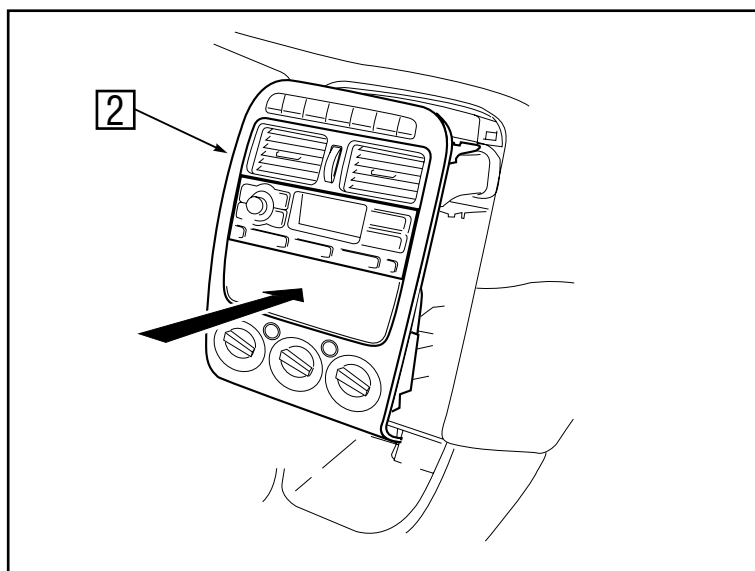

Fig. 6

6. Fit the centre cluster panel 2.

4. 6 DISC CD CHANGER INSTALLATION IN GLOVE BOX

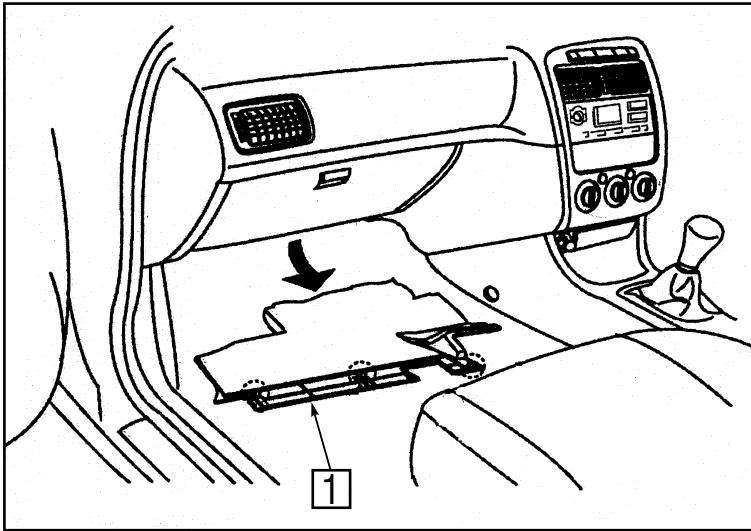
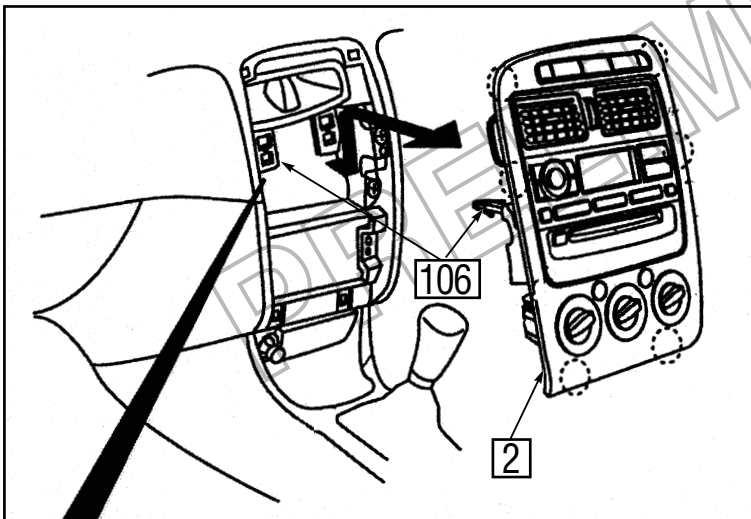

Fig. 7

1. Remove the under cover [1].
○: Clip (3x)



2. Remove the centre cluster panel [2].
○: Clip (6x)
[106]: Hook (2x)

NOTE:
First pull the cluster [2] forward to release the 6 clips ○ then lift the cluster [2] to release the 2 hooks [106].

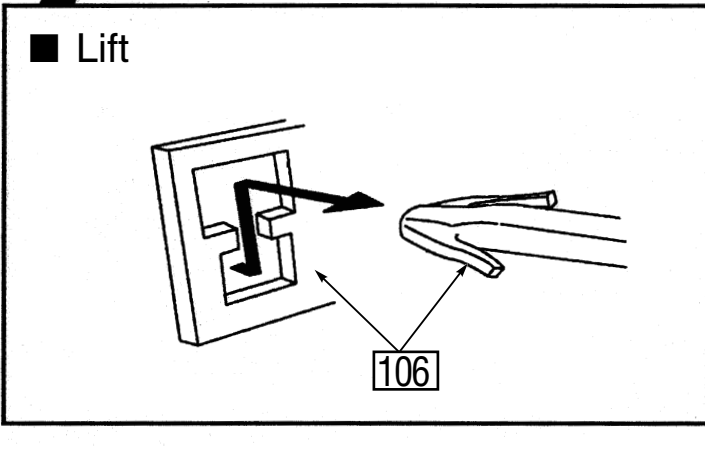

Fig. 8

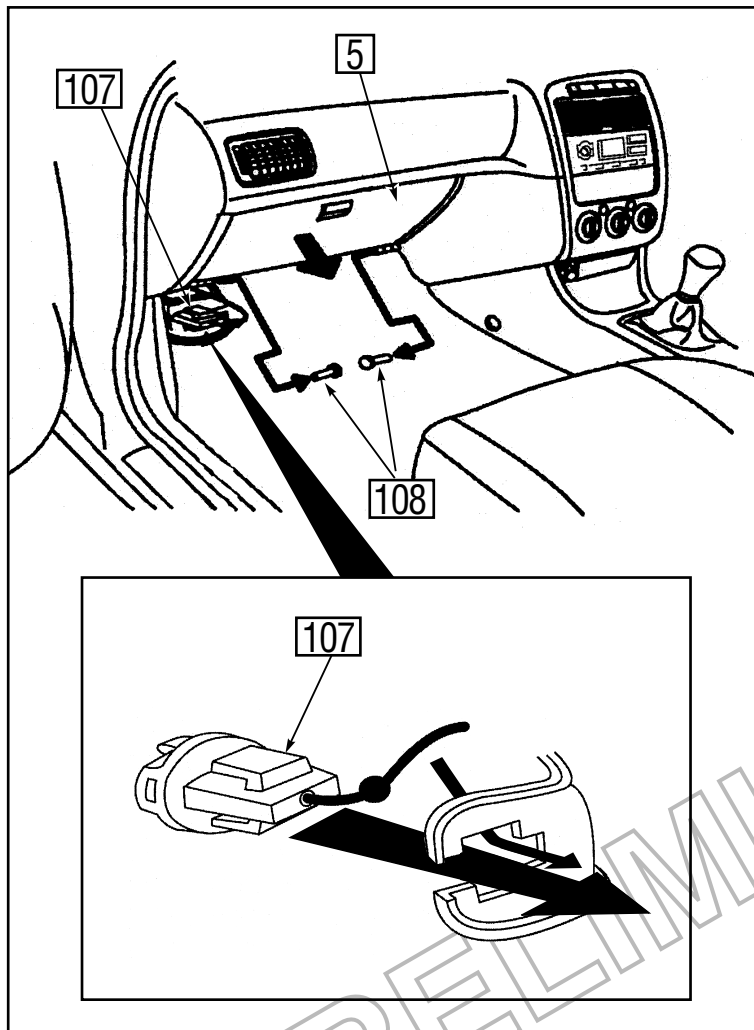

Fig. 9

3.
 - a) Release the glove box buffer hook **107** and pins **108** (2x).
 - b) Remove the glove box **5**.

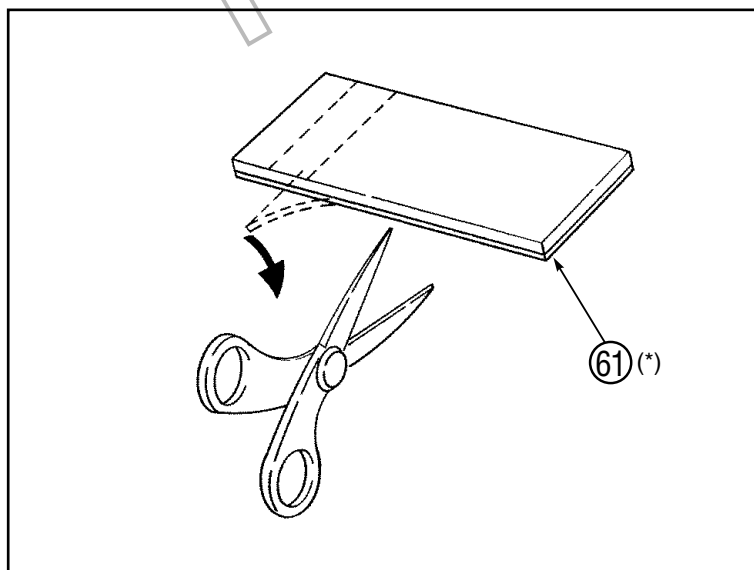

Fig. 10

4. Cut the foam **61** (*) (10 pieces).

(*) Part of mounting kit 08695-05800

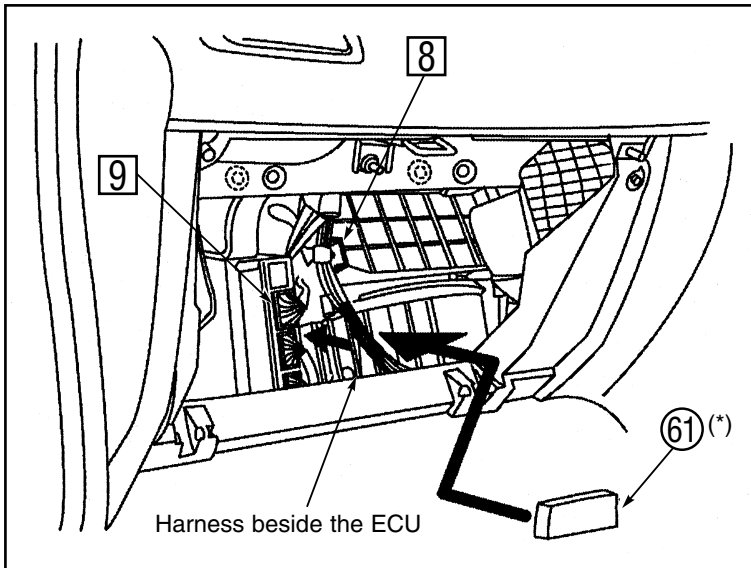

Fig. 11

5.
 - a) Locate and remove the wire harness clamp 8.
 - b) Wrap the wire loom in the foam 61(*).
 - c) Route the wire loom beside the ECU 9.

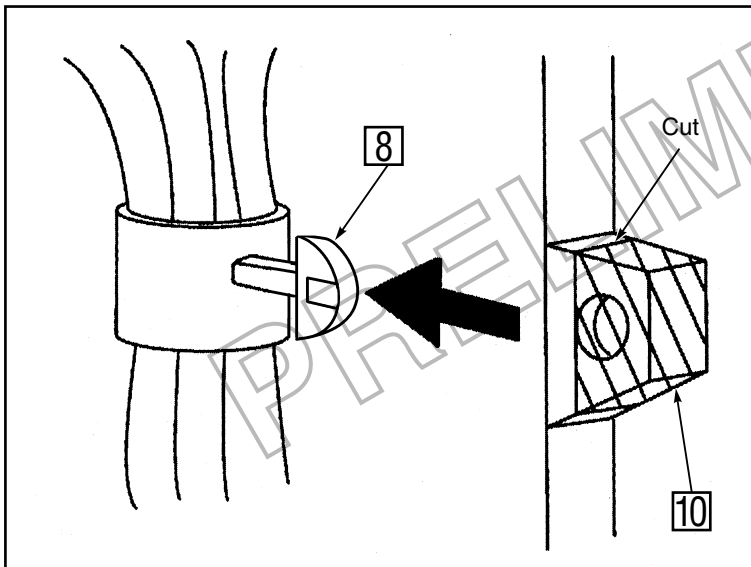

Fig. 12

6. Cut the clamp holder 10.

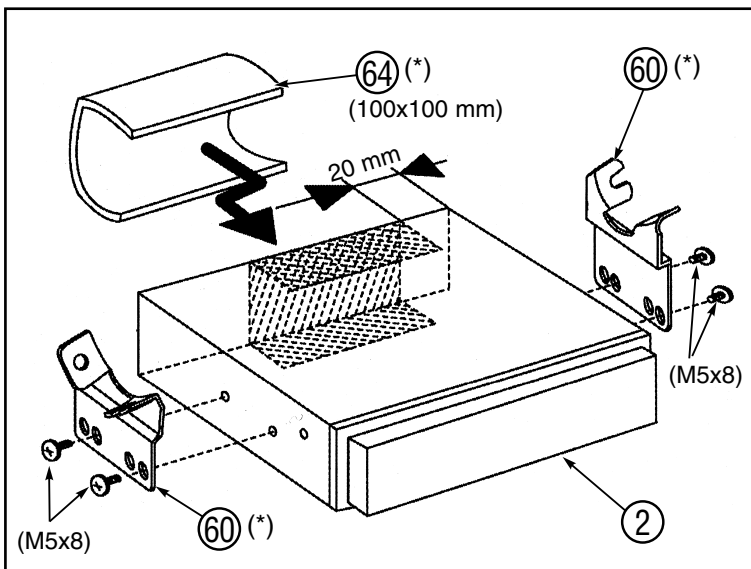

Fig. 13

7. Attach the square adhesive felt 64 (*) and brackets 60 (*) to the CD-changer 2 as shown.

(*) Part of mounting kit 08695-05800

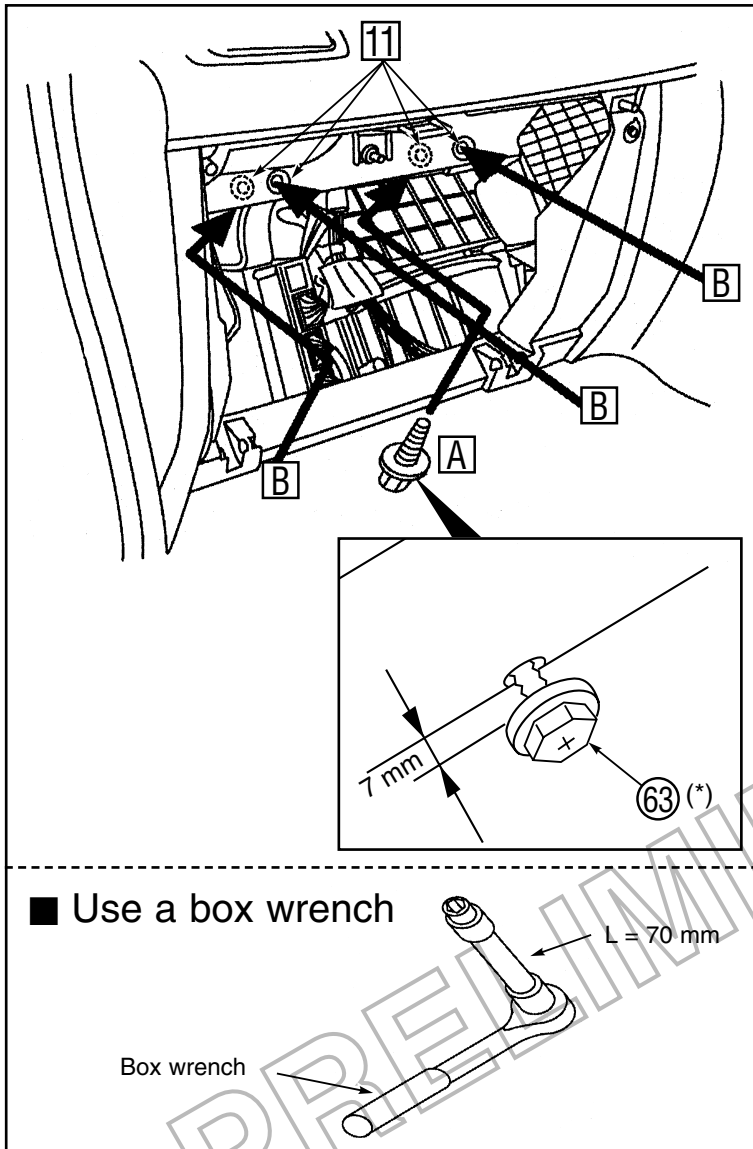

Fig. 14

8.
 - a) Locate the 4 holes 11 in the instrument panel reinforcement.
 - b) Screw a tapping screw 63 (*) in the front right hole A.

NOTE:
 Leave a clearance of about 7 mm.

- c) Tap the other 3 holes using the tapping screws 63 (*) B and remove the screws afterwards.

(*) Part of mounting kit 08695-05800

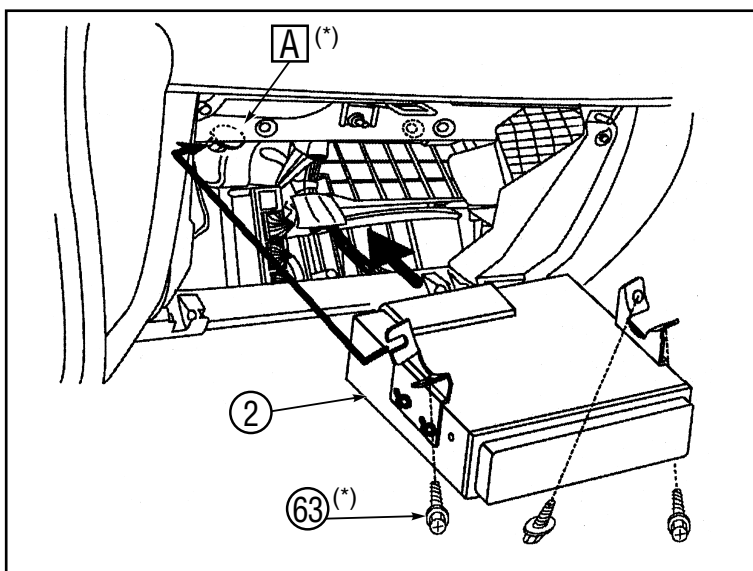

Fig. 15

9. Fit the CD-changer 2 to the reinforcement.
 First position the CD-changer RH-side bracket to the screw 63 A (*) and fit the CD-changer 2 to the reinforcement using the tapping screws 63 (*).

(*) Part of mounting kit 08695-05800

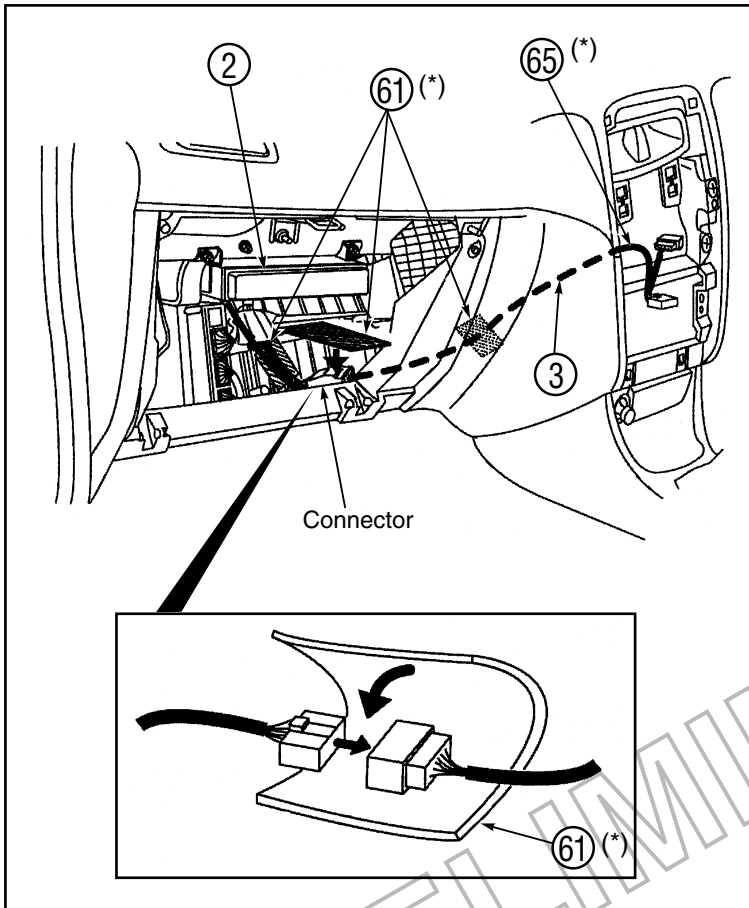

Fig. 16

10.
 - a) Connect the CD-changer wire ③ to the junction cord ⑥⑤ (*) and wrap the connectors in the foam ⑥① (*).
 - b) Route the junction cord ⑥⑤ (*) as shown.

(*) Part of mounting kit 08695-05800

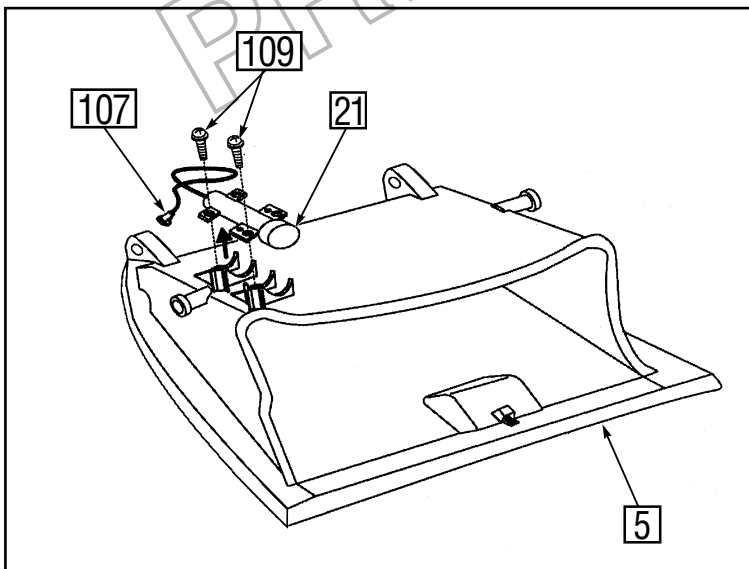

Fig. 17

11. Remove the glove box buffer ②①.
 - ①⑦ : Hook
 - ①⑨ : Screw (2x)

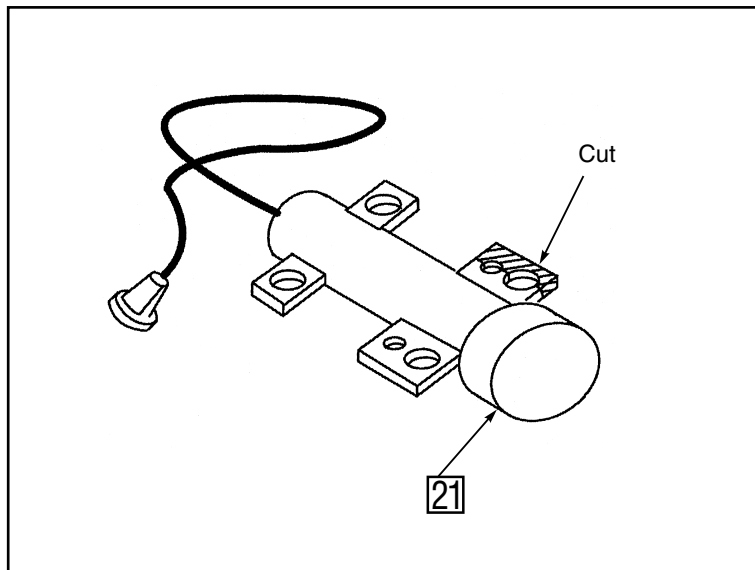

Fig. 18

12. Cut the glove box buffer **21** as shown.

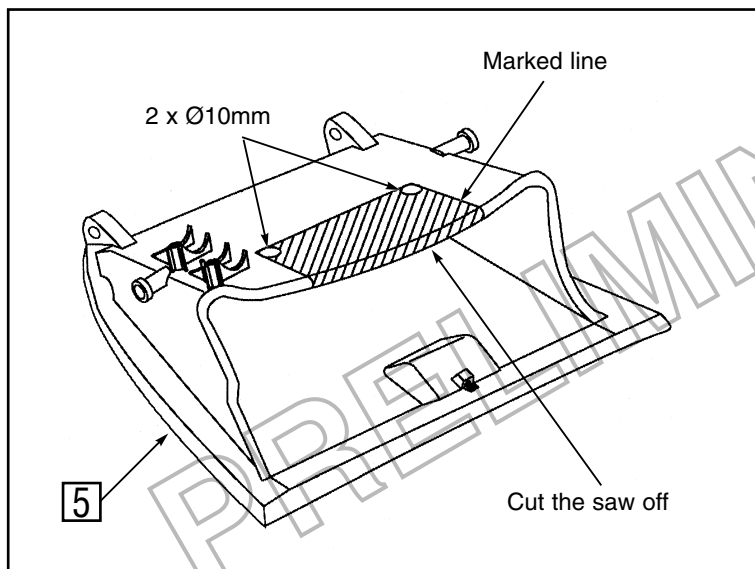

Fig. 19

13.
 a) Drill two holes of 10mm as indicated.
 b) Cut the glove box **5** along the marked line.

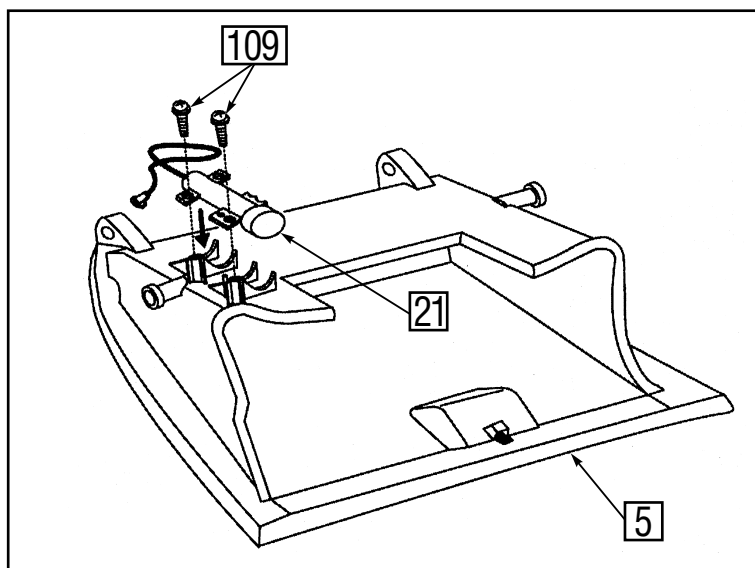

Fig. 20

14. Refit the glove box buffer **21** to the glove box **5**.
109 : Screw (2x)

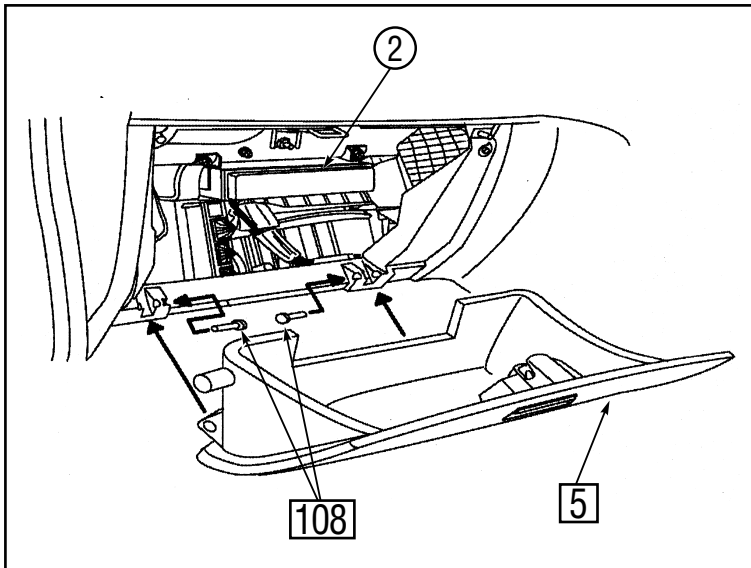

Fig. 21

15. Refit the glove box ⑤.
 ⑩⑧ : Pin (2x)

NOTE:
 Make sur the glove compartment opens and closes smoothly.

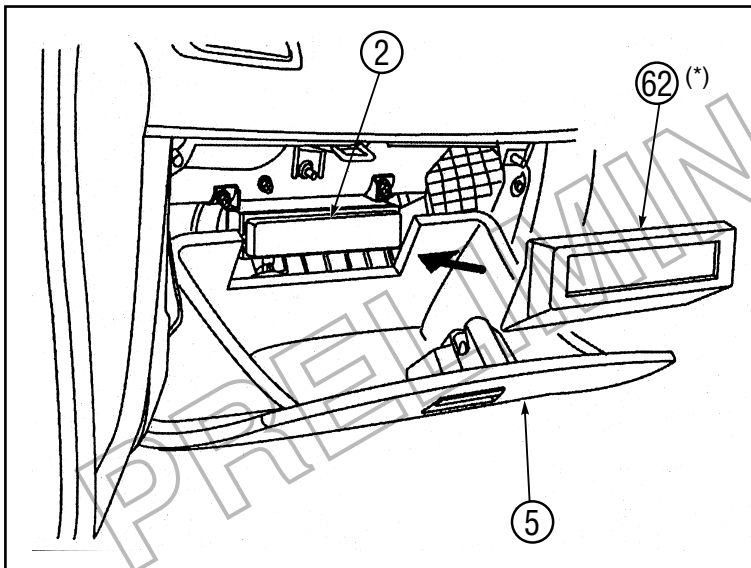

Fig. 22

16. Fit the panel ⑥② (*) to the CD-changer ②.

(*) Part of mounting kit 08695-05800

Refit the trim and removed parts.

5. CD CHANGER INSTALLATION

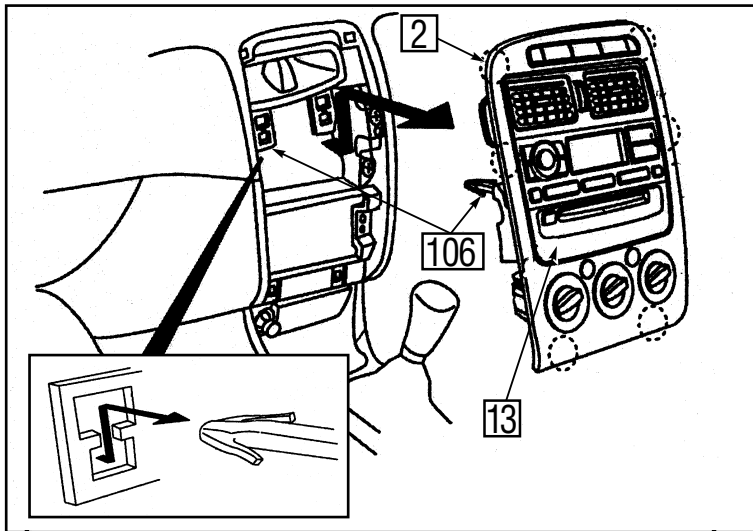

Fig. 23

1. Remove the centre cluster panel **2** and combo **13**.

○ : Clip (6x)

106 : Hook

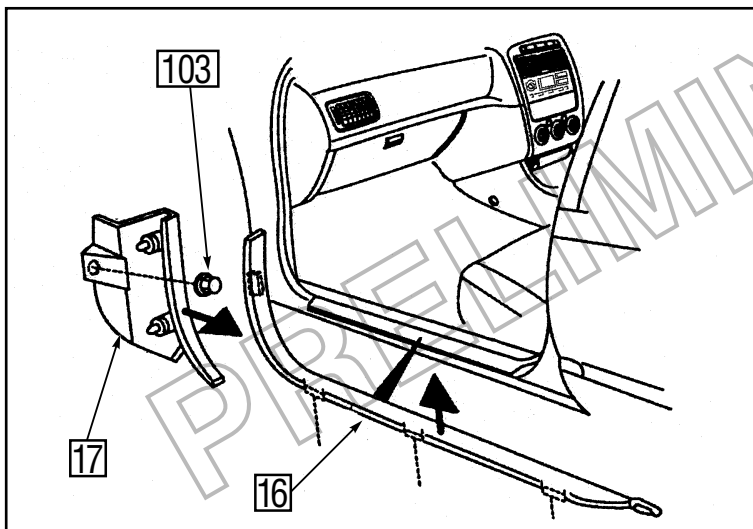

Fig. 24

2. Remove the front scuff plate **16** and cowl side trim **17**.

103 : Nut

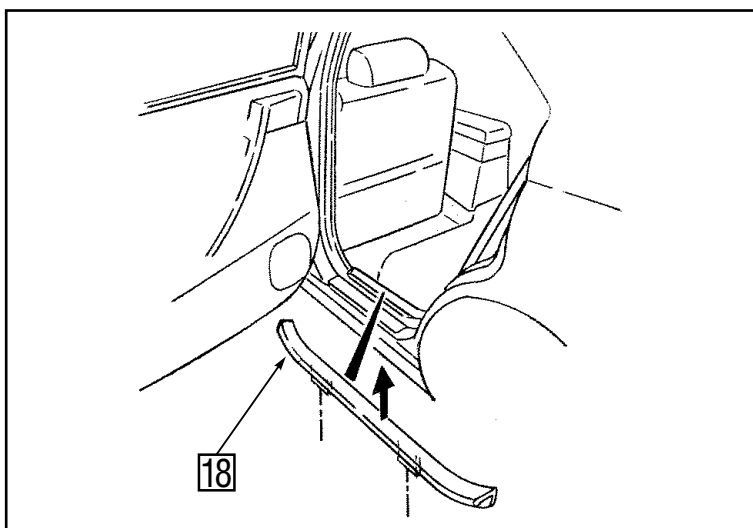

Fig. 25

3. Remove the rear scuff plate **18**.

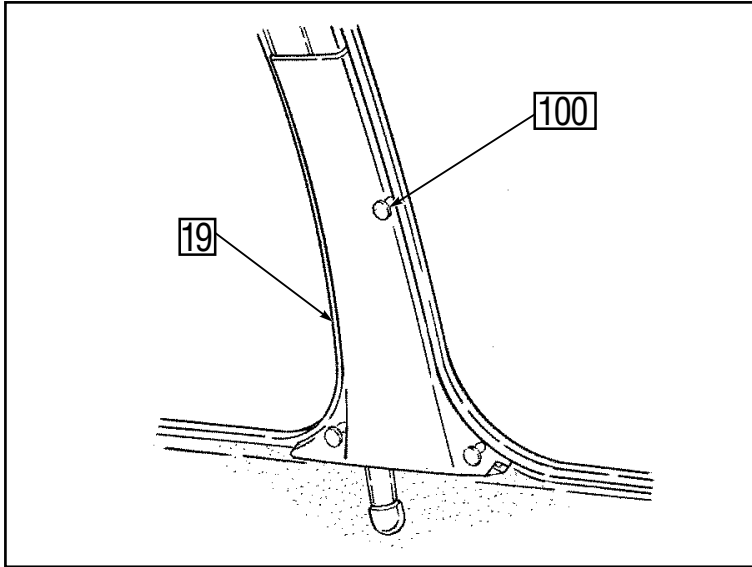

Fig. 26

4. Remove the centre pillar cover 19.
100: Clip (3x)

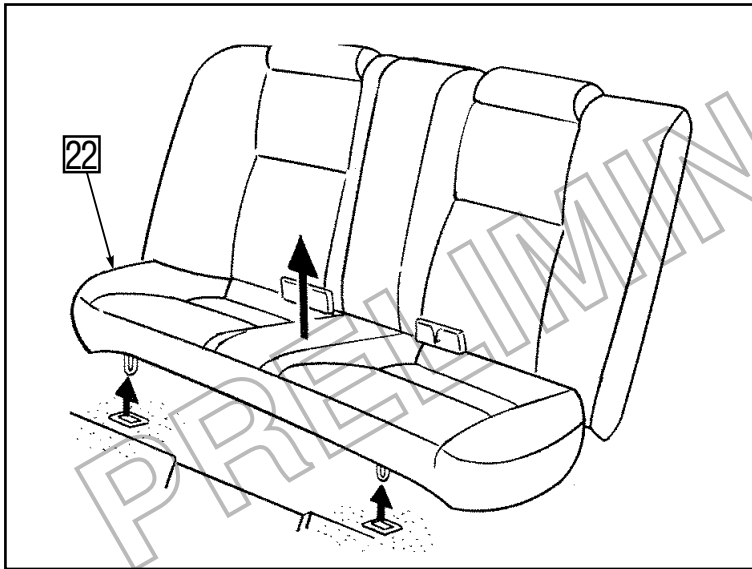

Fig. 27

FOR S/D MODEL

5. Remove the rear seat cushion 22.

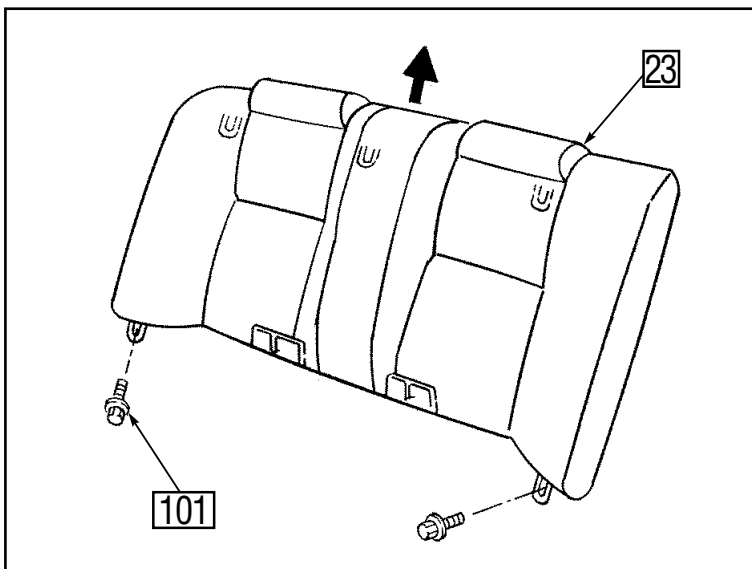

Fig. 28

FOR S/D MODEL

6. Remove the rear seat back 23.
101: Bolt with washer (2x)

CAUTION:
Fasten the bolt using specified torque when reassembling.

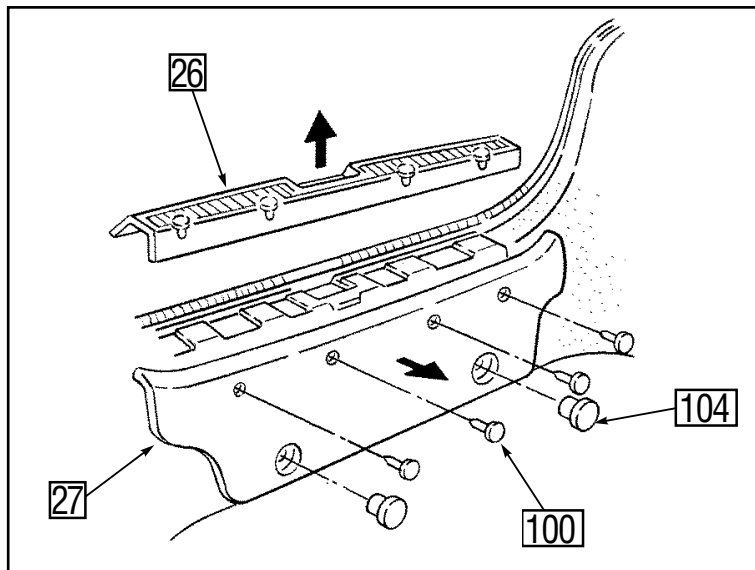

Fig. 29

FOR L/B MODEL

7. Remove the luggage finish plate 26 and luggage rear trim 27.

100: Clip (4x)

104: Clip (2x)

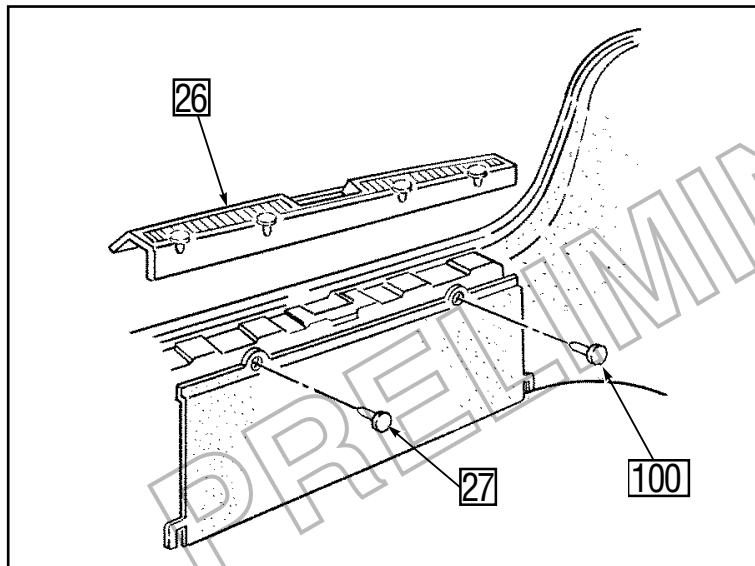

Fig. 30

FOR S/D MODEL

8. Remove the luggage finish plate 26 and luggage rear trim 27.

100: Clip (2x)

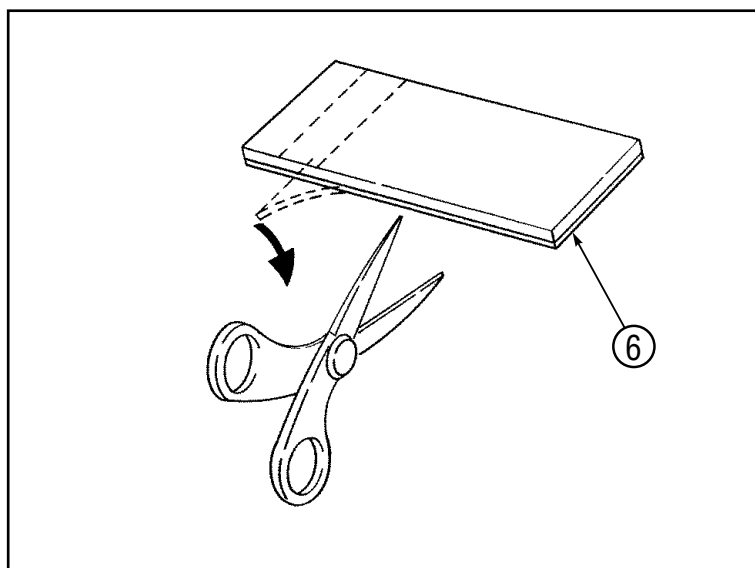

Fig. 31

9. Cut the tape 6 (10 pieces).

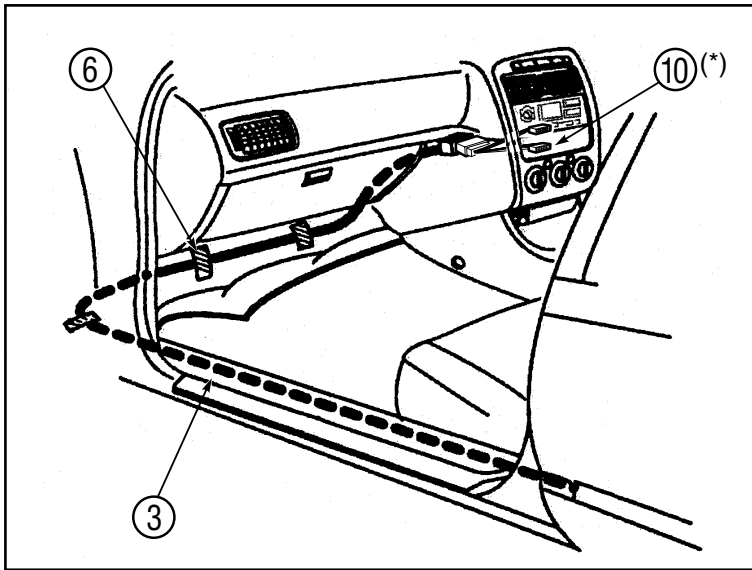

Fig. 32

- 10. Route the changer wire ③ and connect the junction cord ⑩ (*).
⑥: Tape (3x)

(*) Junction cord 08695-00260 to be ordered separately.

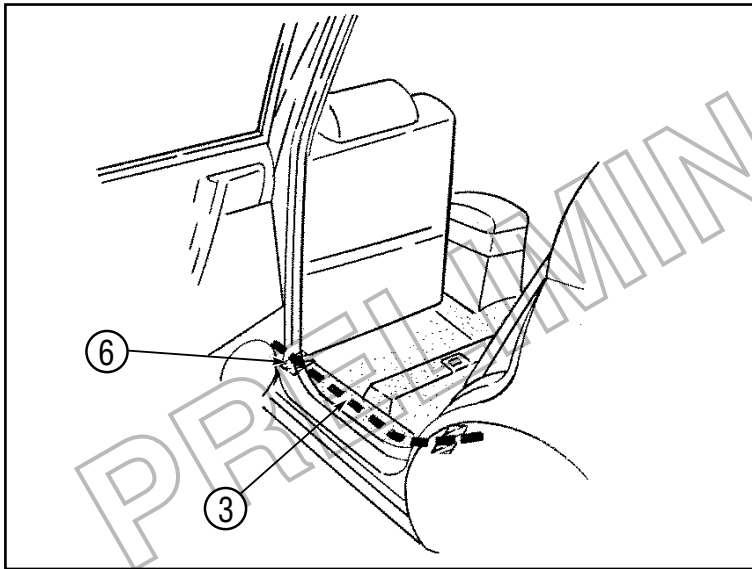

Fig. 33

- 11. Route the changer wire ③.
⑥: Tape (2x)

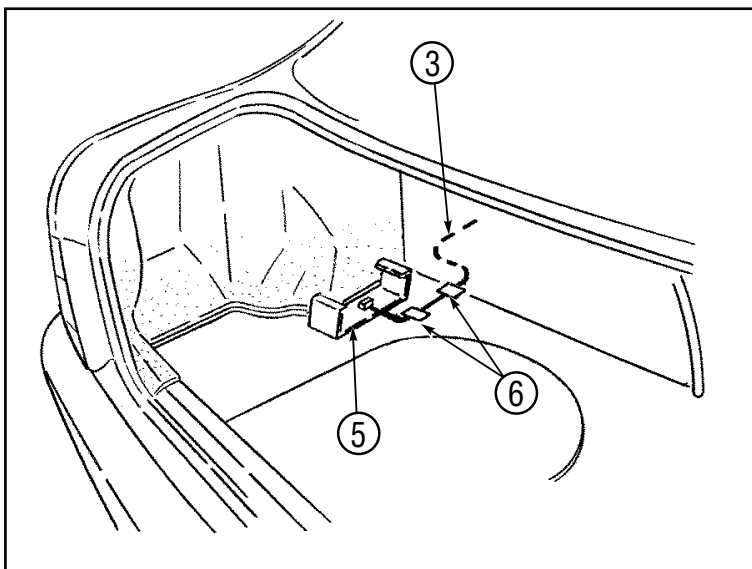

Fig. 34

FOR S/D MODEL

- 12. Route the changer wire ③.
⑥: Tape (5x)

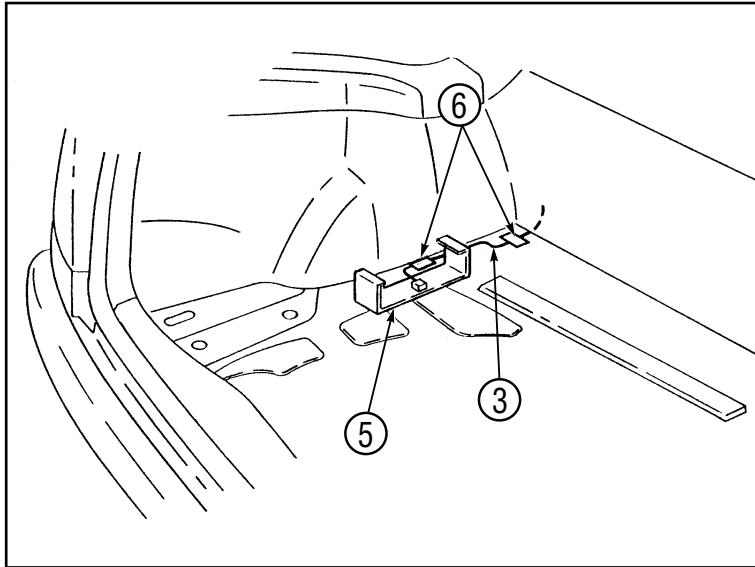

Fig. 35

FOR L/B OR W/G MODEL

13. Route the changer wire ③.
⑥: Tape (5x)

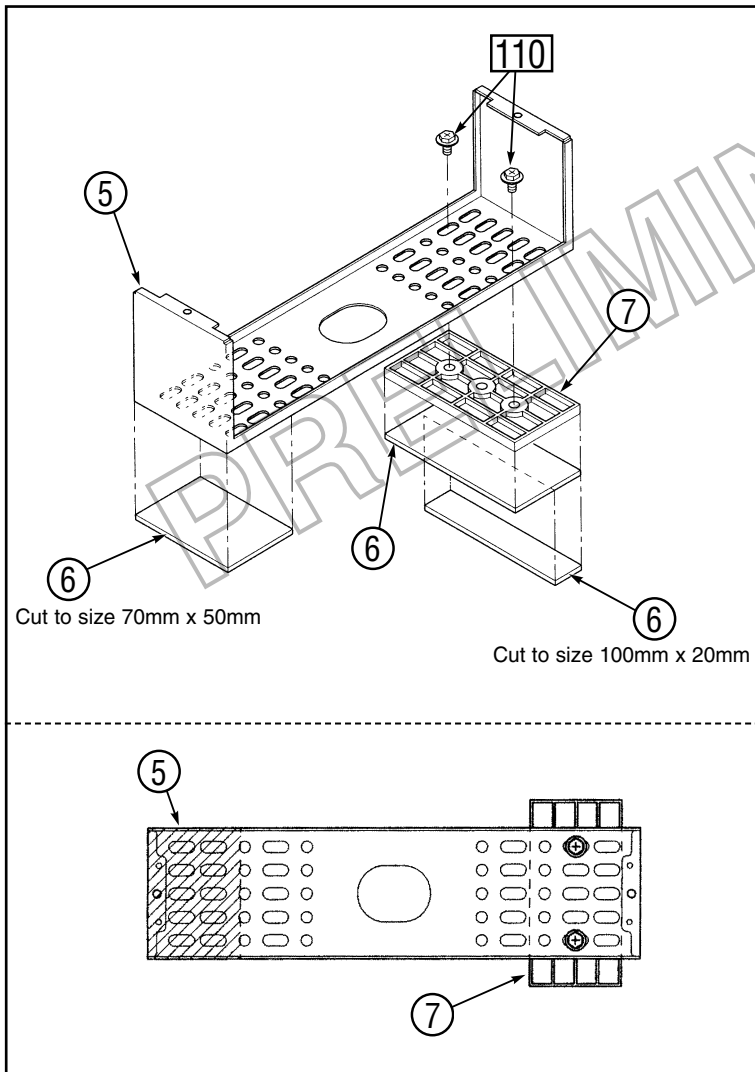

Fig. 36

FOR S/D MODEL

14. Remove the luggage carpet ③ before the installation.
15. Attach the tape ⑥ and spacer ⑦ to the base bracket ⑤.
⑪⑩: Screw (2x)

 - Component parts of CD changer ①.

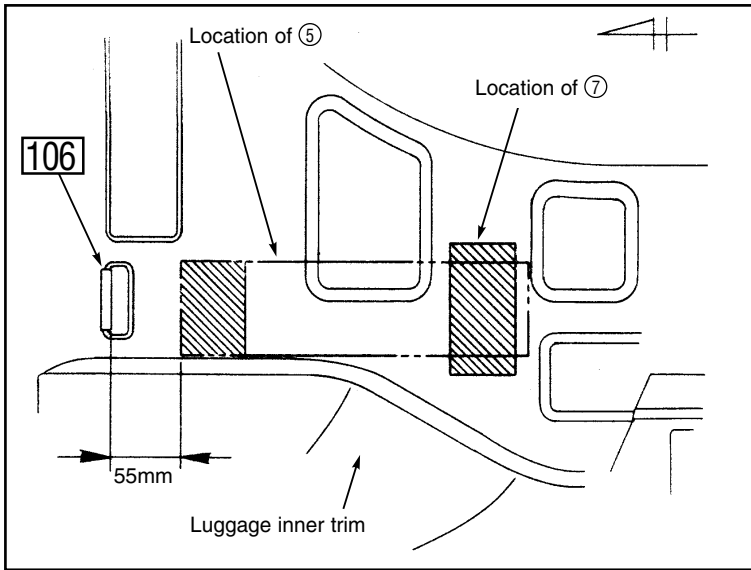

Fig. 37

- 16. Locate the base bracket ⑤ on the floor.
106: Hook

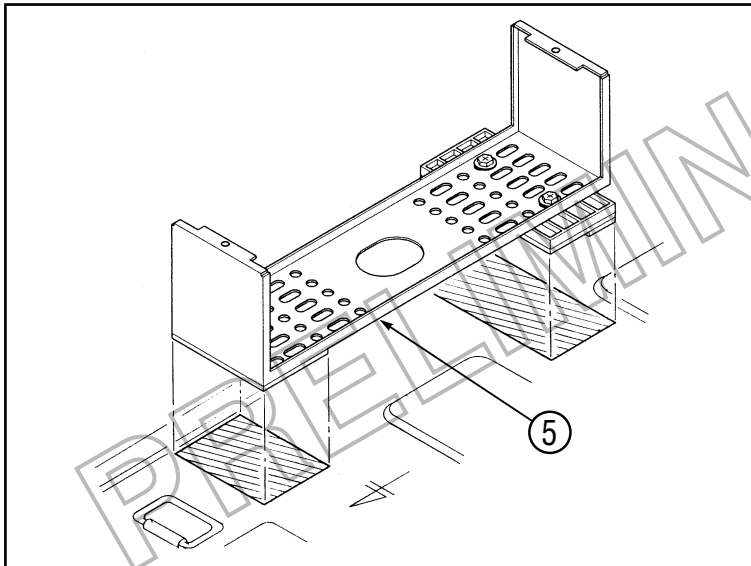

Fig. 38

- 17. Attach the base bracket ⑤ on the floor.

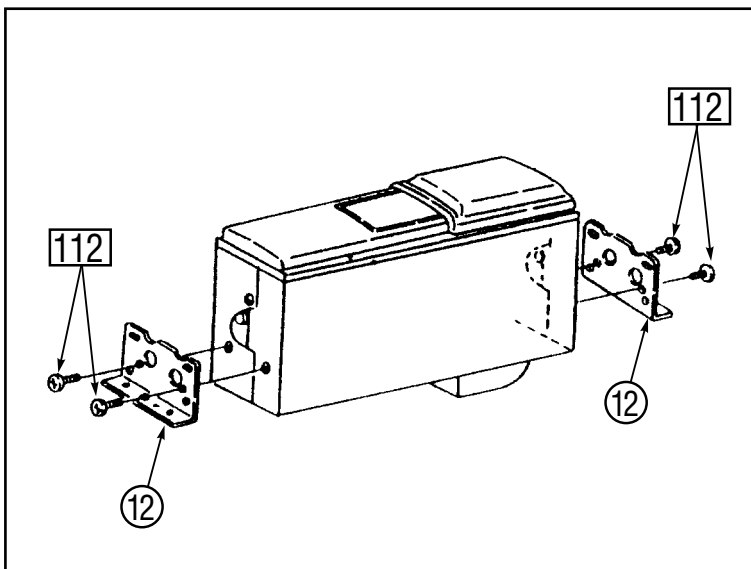

Fig. 39

- 18. Fit the side brackets ⑫ (2x) to the changer unit ①.
112: Screw (4x)

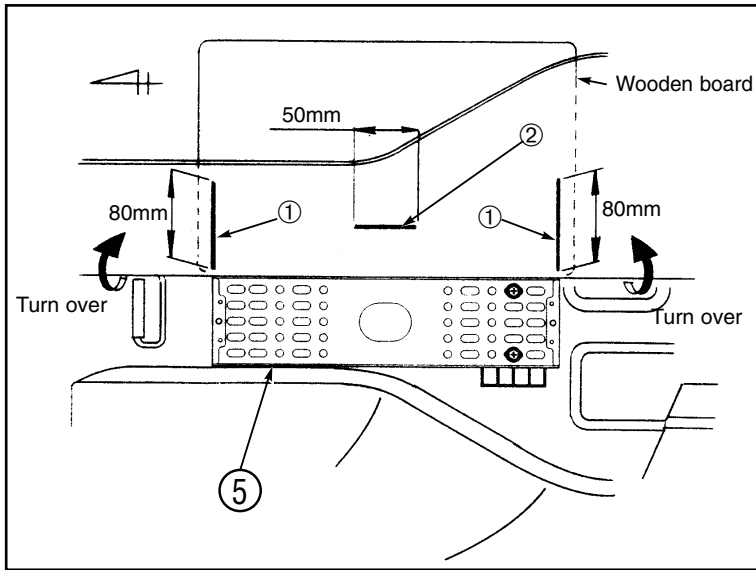

Fig. 40

19. Replace the luggage carpet ③ and make slits at two places for the base bracket ⑤ to come through.

NOTE:

- ① Cut the carpet ③ for the base bracket ⑤ (2 places).
- ② Cut the carpet ③ for the changer wire ③ and ground wire ⑪ (1 place).

CAUTION:

Use a wooden board under the laid carpet to protect it when making cuts.

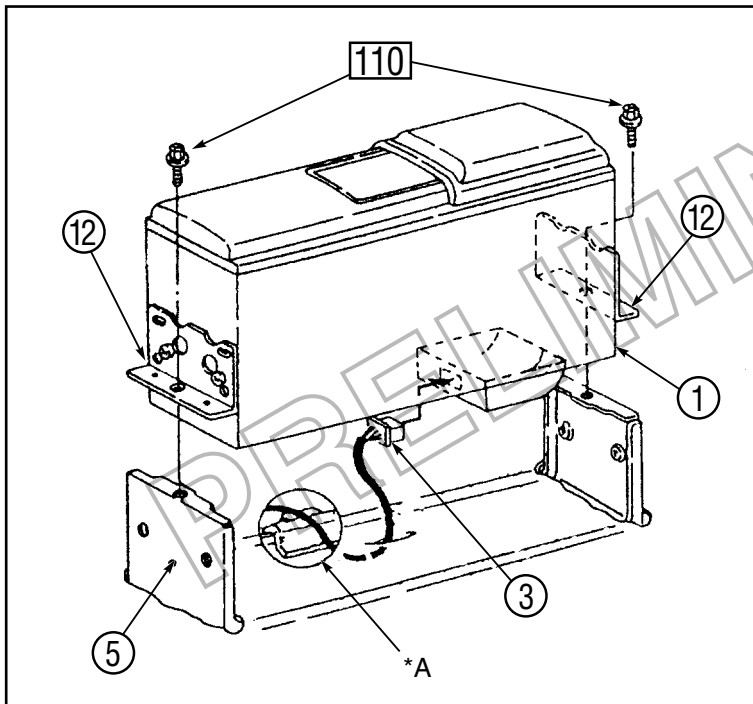

Fig. 41

20. Reposition the carpet ③ and place the base bracket ⑤ underneath it. Also make the changer wire ③ go through the carpet ③.

CAUTION:

Cover the edge of the base bracket ⑤ where the changer wire ③ crosses it. (See position *A)

21. Connect the changer wire ③ to the changer unit ①. Then fit the changer unit ① to the base bracket ⑤.
⑪⑫: Screw (4x)

FOR L/B AND W/G MODEL

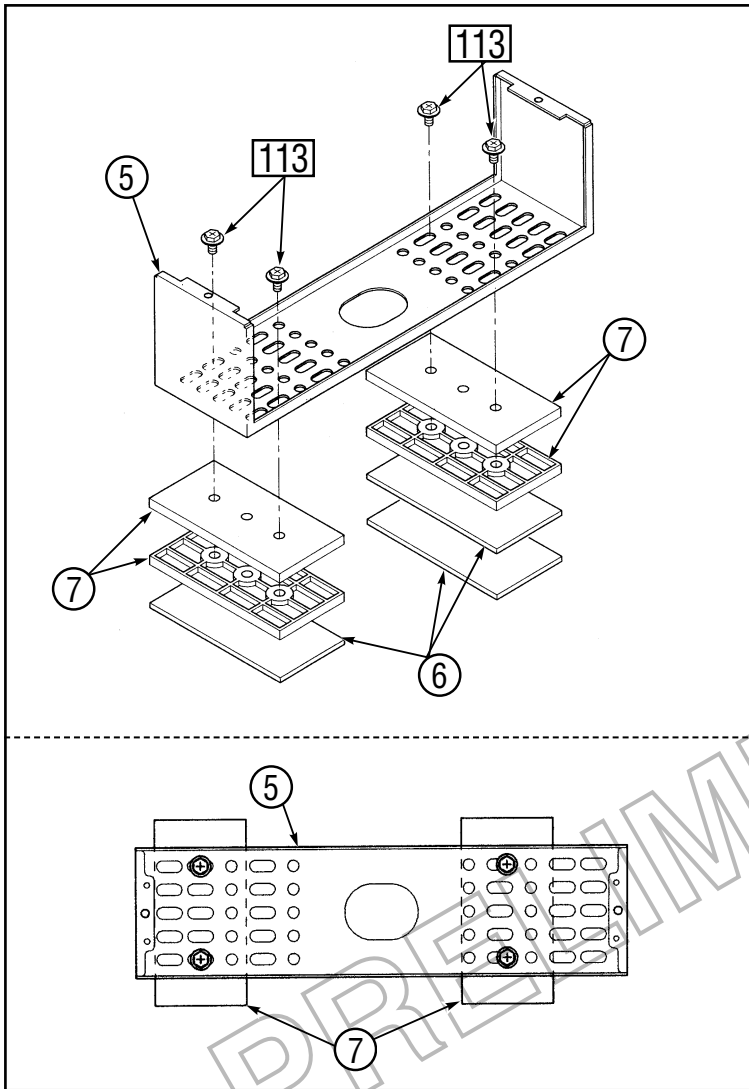

14. Remove the luggage carpet ③ before installation.

15. Attach the tape ⑥ and spacer ⑦ to the base bracket ⑤.

⑪⑬: Screw (4x)

● Component parts of CD changer ①.

Fig. 42

16. Locate the base bracket ⑤ on the floor.

⑪⑯: Hook

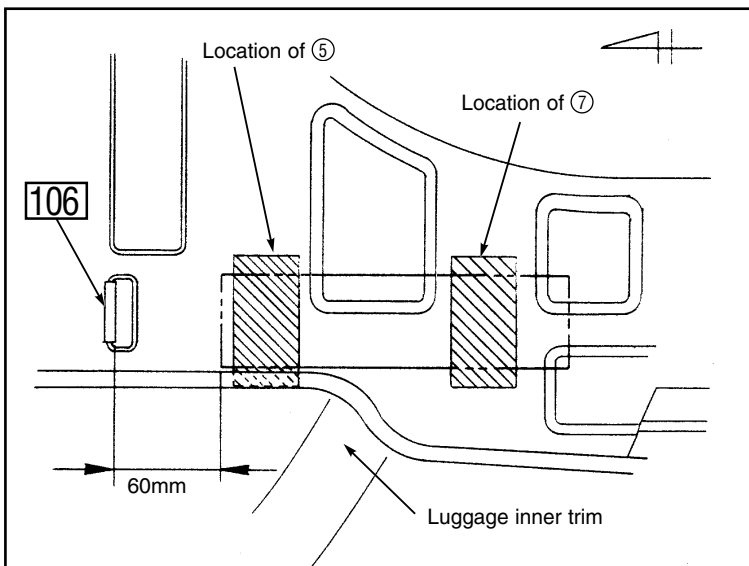

Fig. 43

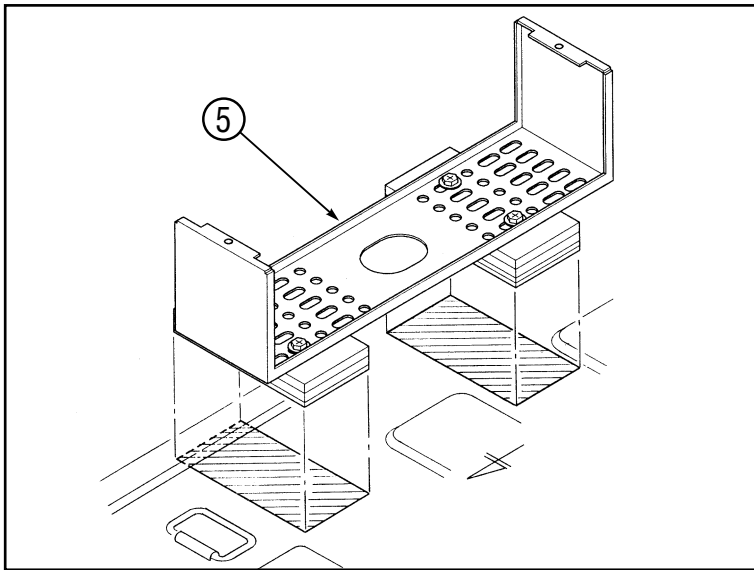

Fig. 44

17. Attach the base bracket ⑤ on the floor.

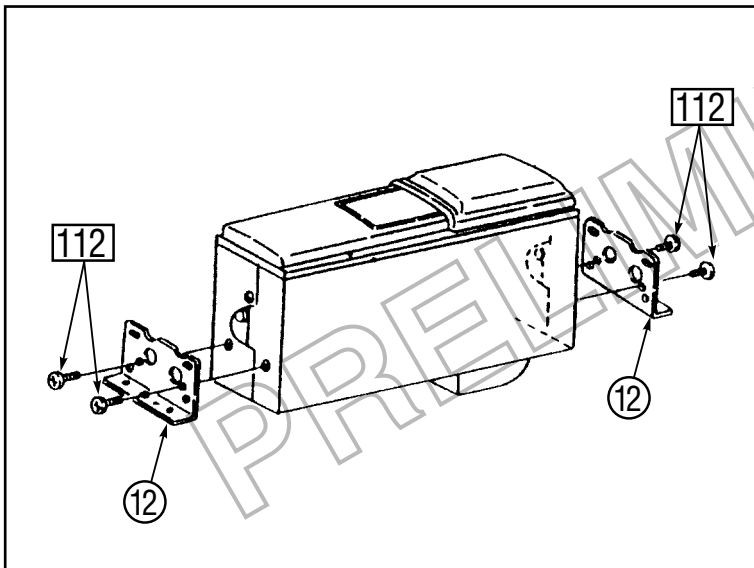

Fig. 45

18. Fit the side brackets ⑫ (2x) to the changer unit ①.
 ⑪⑫: Screw (4x)

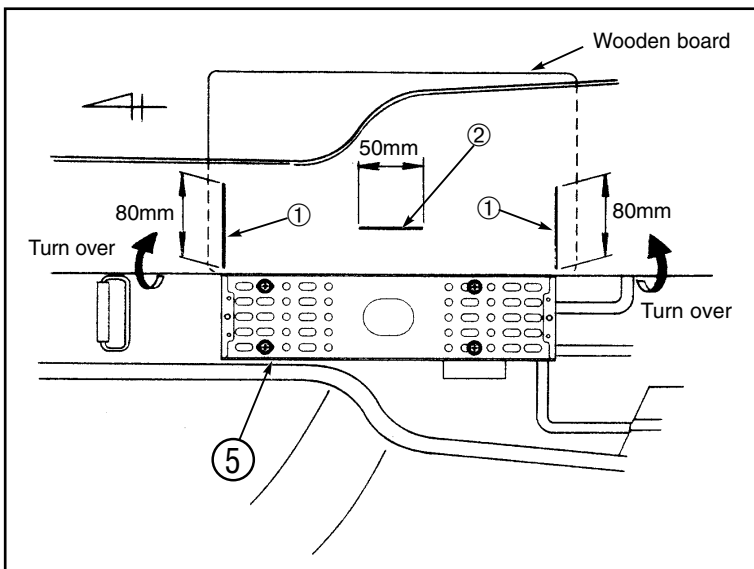

Fig. 46

19. Replace the luggage carpet ③ and make slits at two places for the base bracket ⑤ to come through.

NOTE:

- ① Cut the carpet ③ for the base bracket ⑤ (2 places).
- ② Cut the carpet ③ for the changer wire ② and ground wire ⑪ (1 place).

CAUTION:

Use a wooden board under the laid carpet to protect it when making cuts.

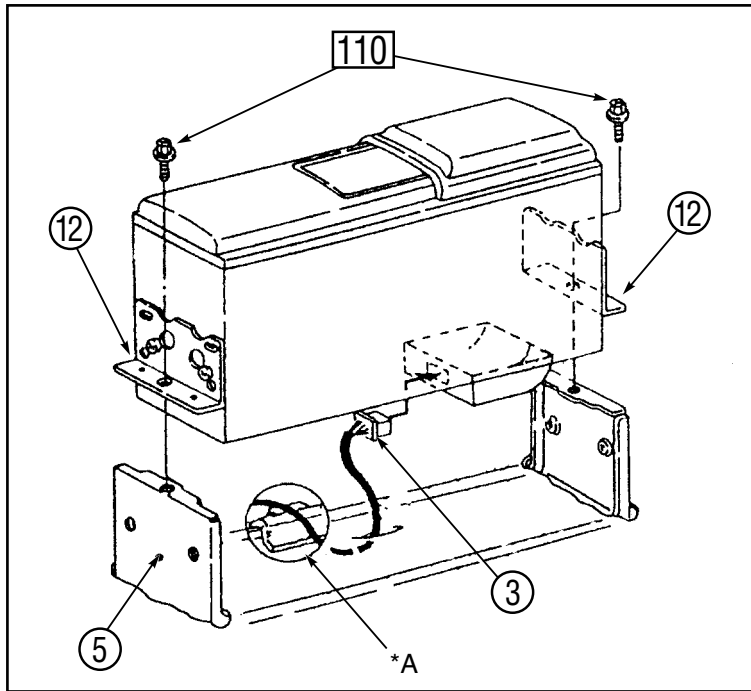

Fig. 47

20. Reposition the carpet ③ and place the base bracket ⑤ underneath it. Also make the changer wire ③ go through the carpet ③.

CAUTION:

Cover the edge of the base bracket ⑤ where the changer wire ③ crosses it. (See position *A)

21. Connect the changer wire ③ to the changer unit ①. Then fit the changer unit ① to the base bracket ⑤.

PRELIMINARY

6. MD CHANGER INSTALLATION

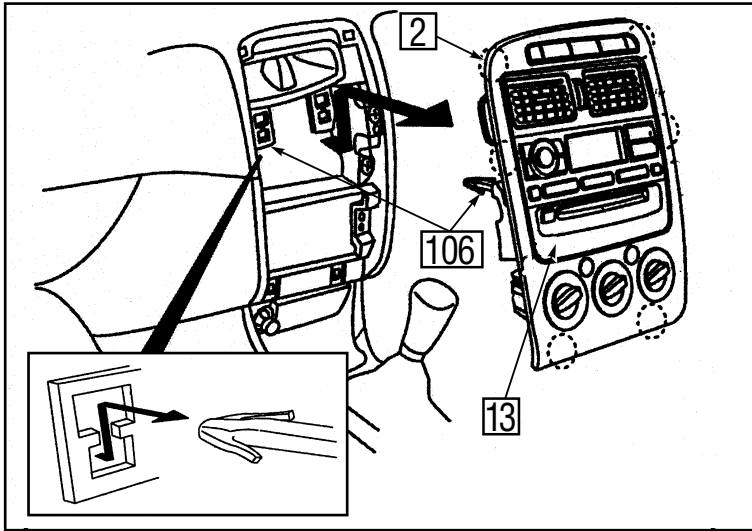

Fig. 48

1. Remove the centre cluster panel **2** and combo **13**.
 ○: Clip (6x)
106: Hook

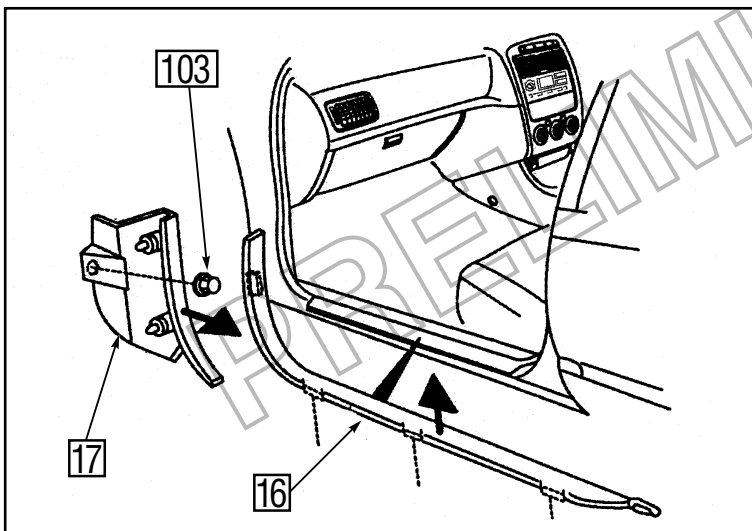

Fig. 49

2. Remove the front scuff plate **16** and cowl side trim **17**.
103: Nut

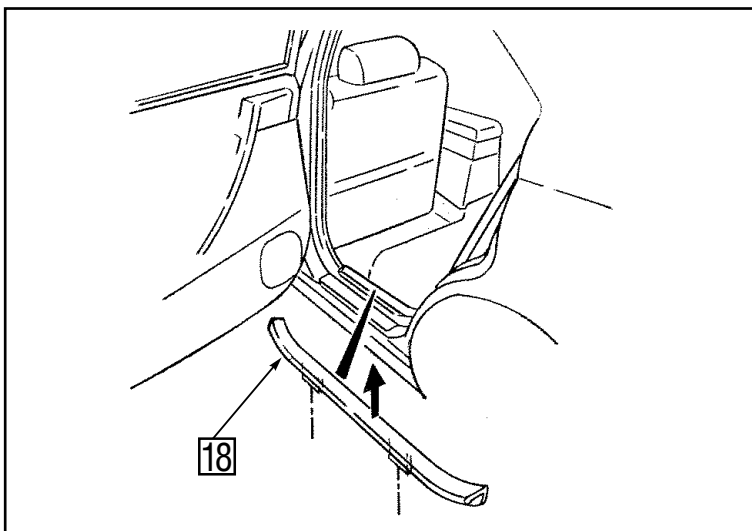

Fig. 50

3. Remove the rear scuff plate **18**.

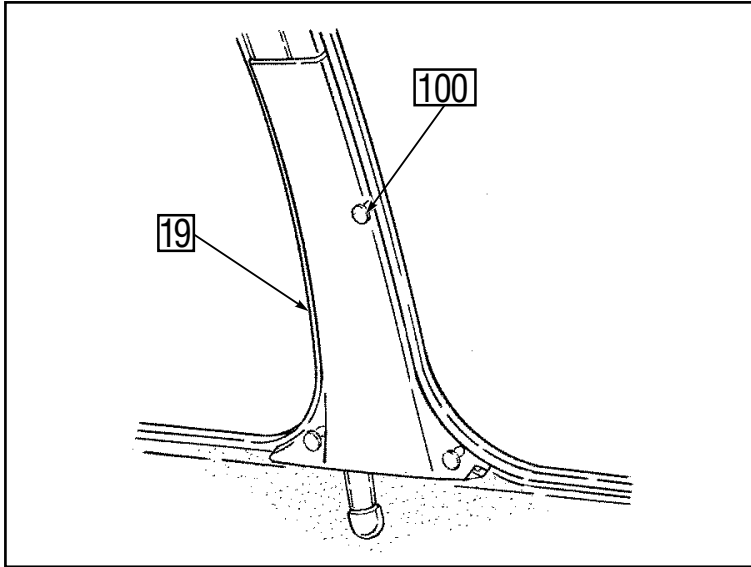

Fig. 51

4. Remove the centre pillar cover 19.
100: Clip (3x)

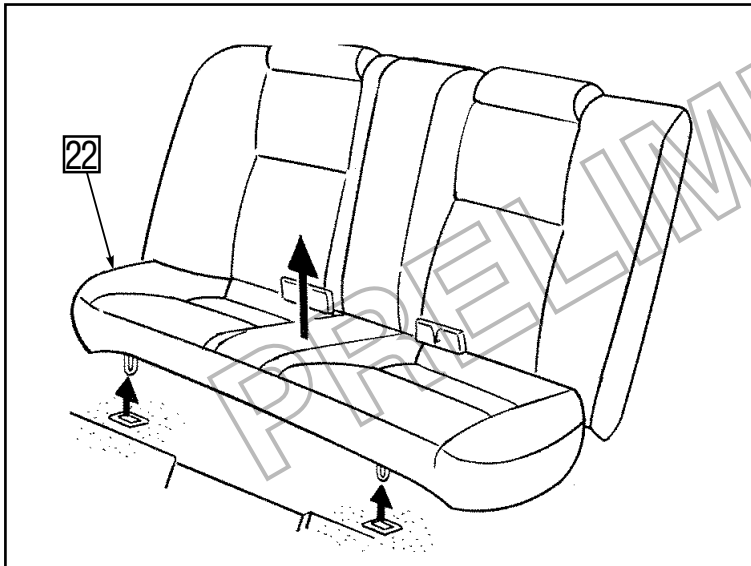

Fig. 52

FOR S/D MODEL

5. Remove the rear seat cushion 22.

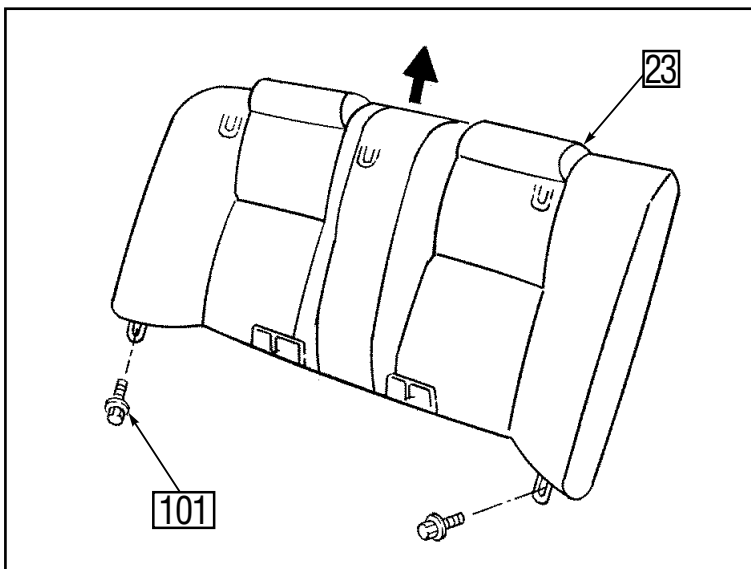

Fig. 53

FOR S/D MODEL

6. Remove the rear seat back 23.
101: Bolt with washer (2x)

CAUTION:
Fasten the bolt using specified torque when reassembling.

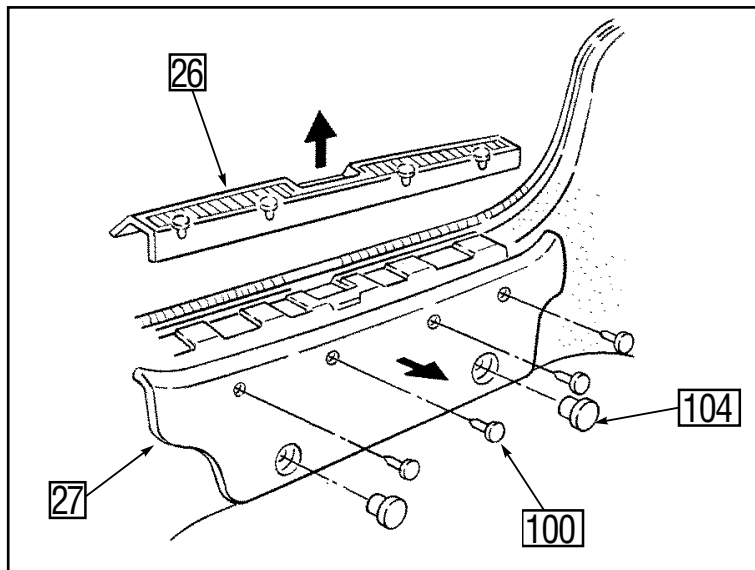

Fig. 54

FOR L/B MODEL

7. Remove the luggage finish plate 26 and luggage rear trim 27.

100: Clip (4x)

104: Clip (2x)

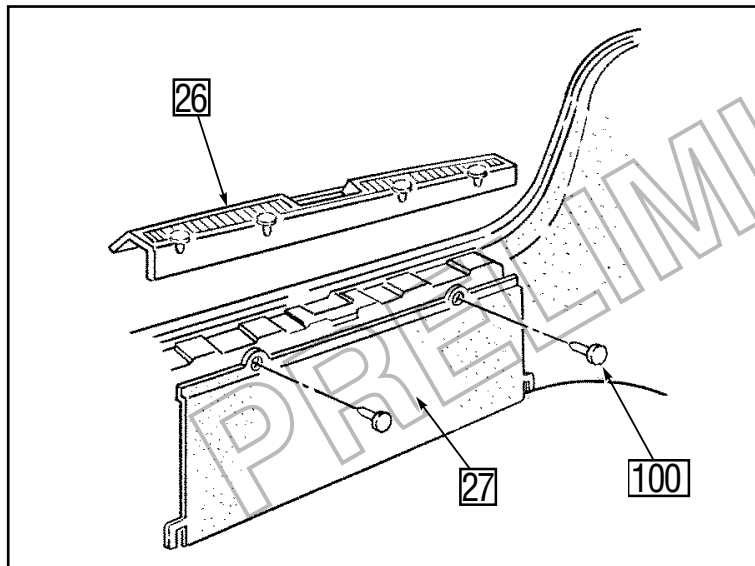

Fig. 55

FOR S/D MODEL

8. Remove the luggage finish plate 26 and luggage rear trim 27.

100: Clip (2x)

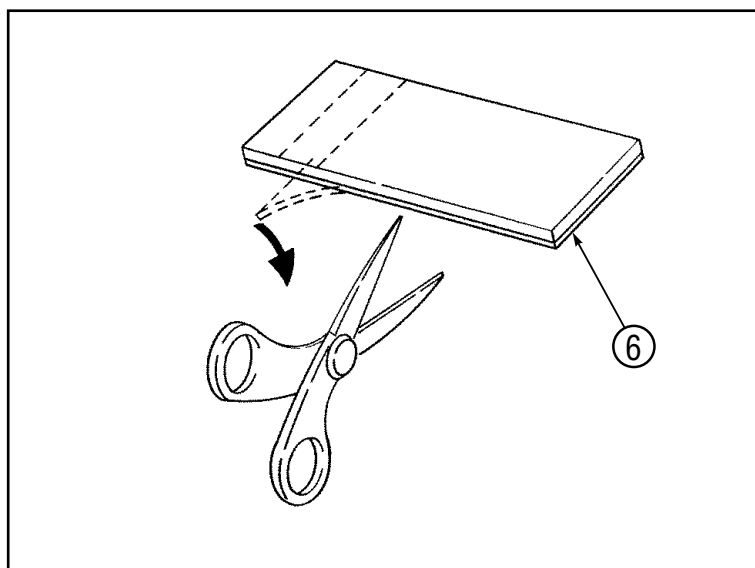

Fig. 56

9. Cut the tape 6 (10 pieces).

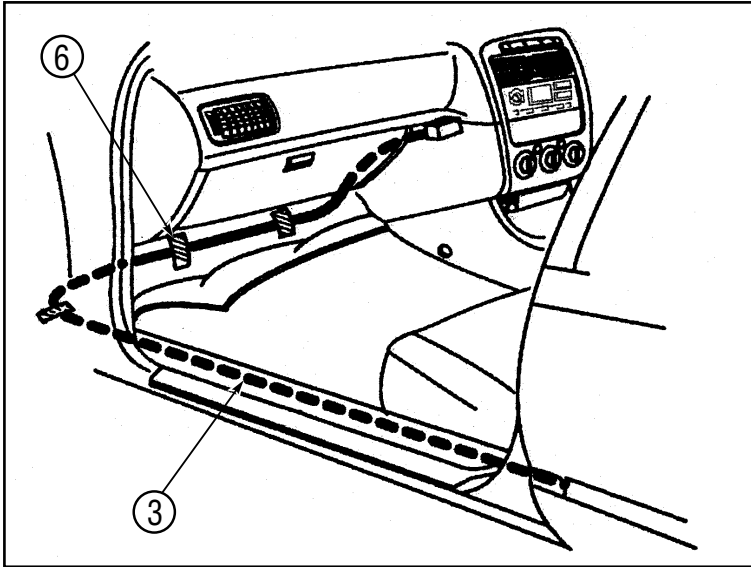

Fig. 57

- 10. Route the changer wire (3).
- (6): Tape (3x)

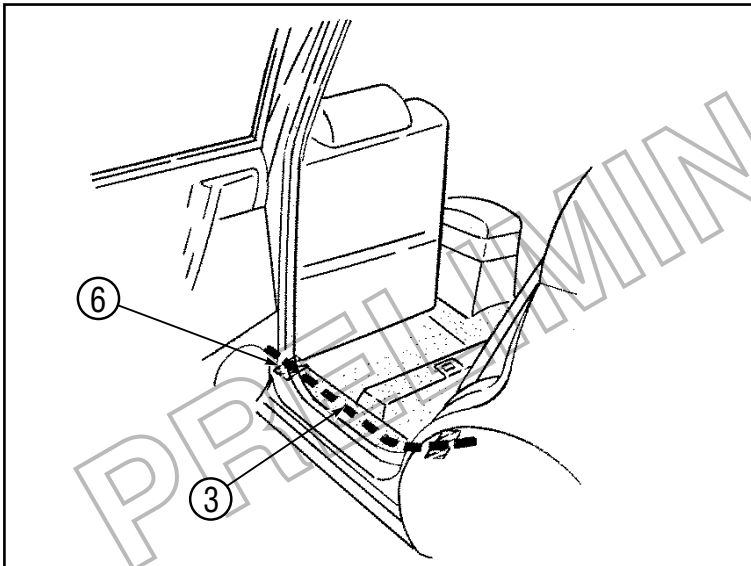

Fig. 58

- 11. Route the changer wire (3).
- (6): Tape (2x)

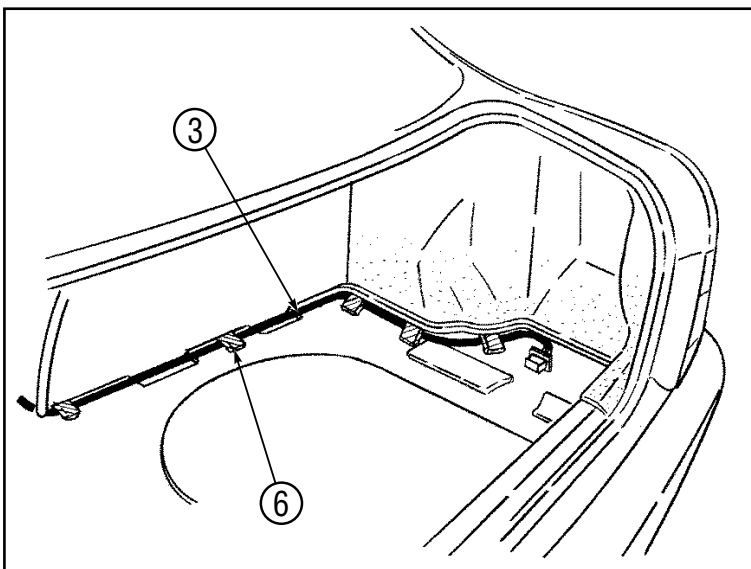

Fig. 59

- 12. Route the changer wire (3).
- (6): Tape (5x)

ADD THE GROUND WIRE TO THE APPROPRIATE GROUND LOCATION.



7. TWEETERS INSTALLATION

Tweeters in mirror cover

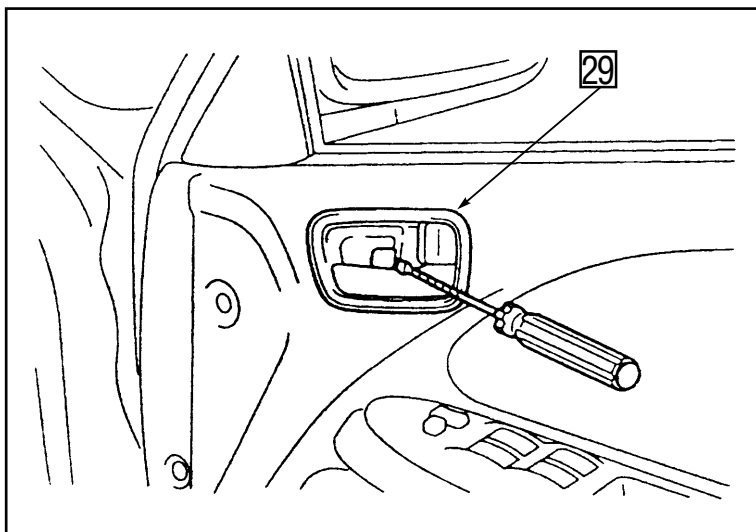

Fig. 60

FOR ALL VEHICLES

1.
 - a) Remove the inside handle bezel 29.
 - b) Using a screwdriver, raise up the plug.
 - c) Remove the screw.
 - d) Using a screwdriver, pry out the bezel.

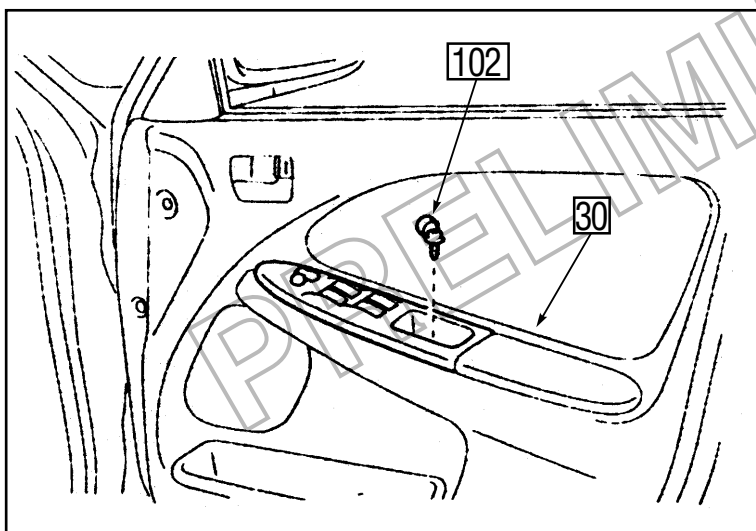

Fig. 61

2.
 - a) Remove the screw.
 - b) Remove the power window switch board 30.
 - c) Disconnect the 14P connector underneath.

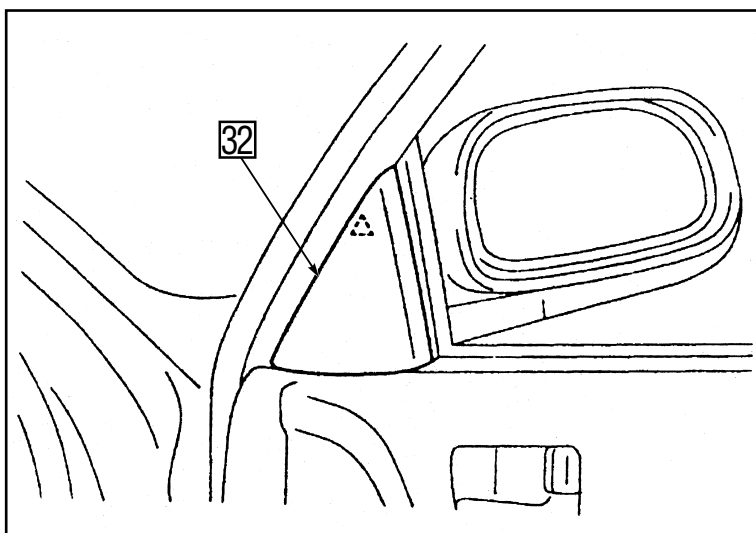

Fig. 62

3. Remove the mirror cover 32.
 △: Clip (1x)

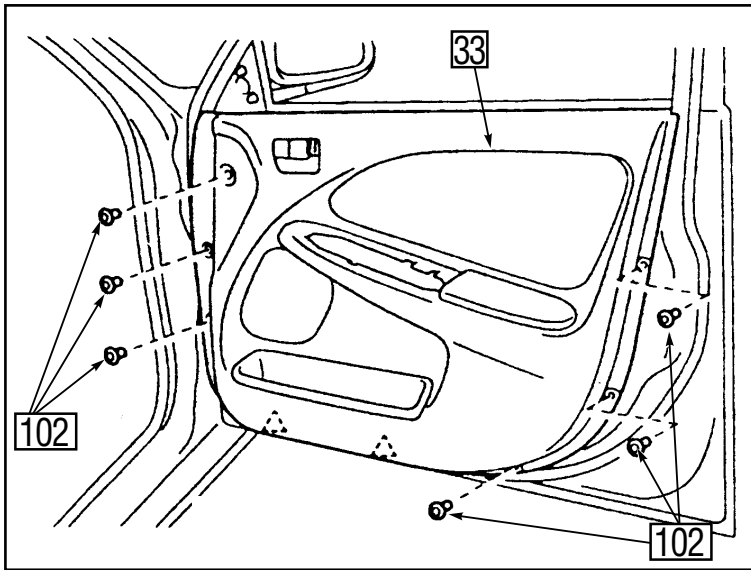

Fig. 63

4.
 - a) Remove the door trim 33.
 - b) Remove the 2 clips and 6 screws.
 △: Clip (2x)
 102: Screw (6x)
 - c) Pull the door trim upward to remove it.
 - d) Pull out from bottom, then lift the whole panel to remove it the lining.

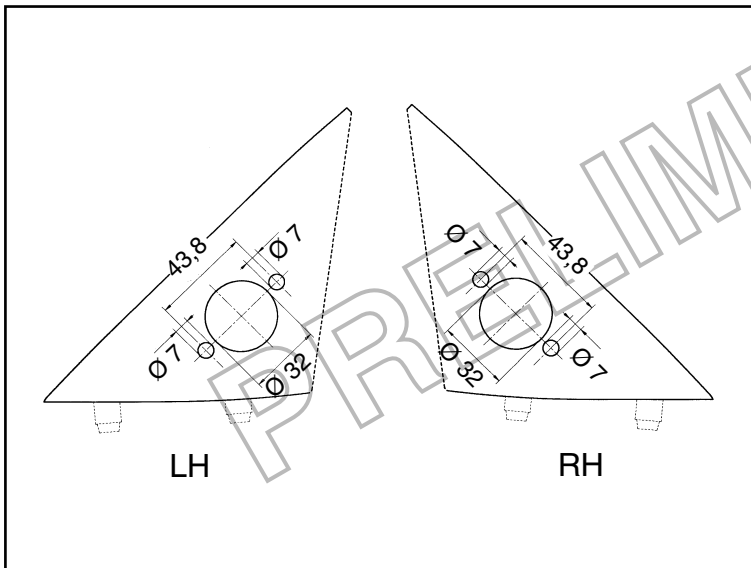

Fig. 64

5.
 - a) Cut out both templates and put it on the mirror covers.
 - b) Measure and mark the hole centres.
 - c) Drill 2 holes of 7 mm.
 - d) Drill a hole of 32 mm.

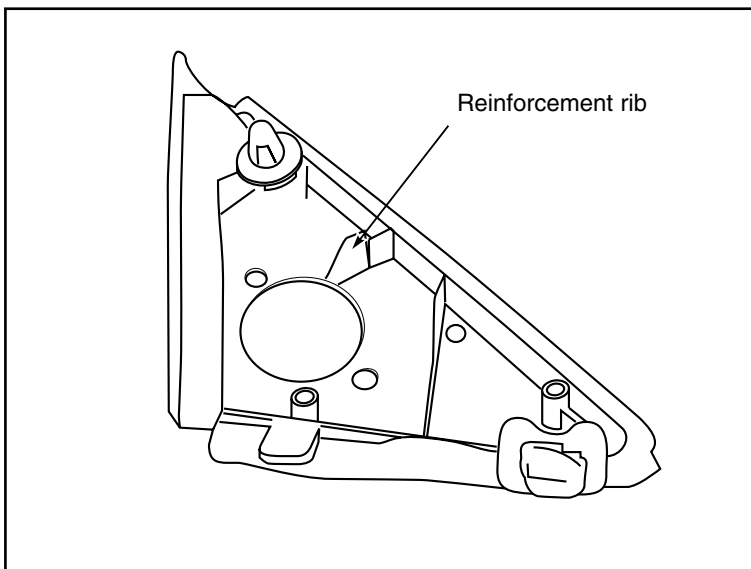

Fig. 65

6. Cut away the reinforcement rib.

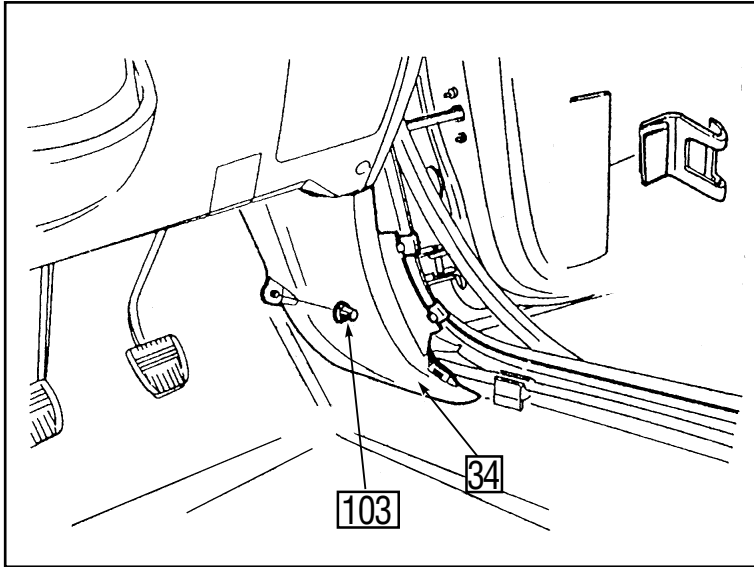

Fig. 66

7. Remove the kick panel **34** on both sides.
103: Nut (1x)

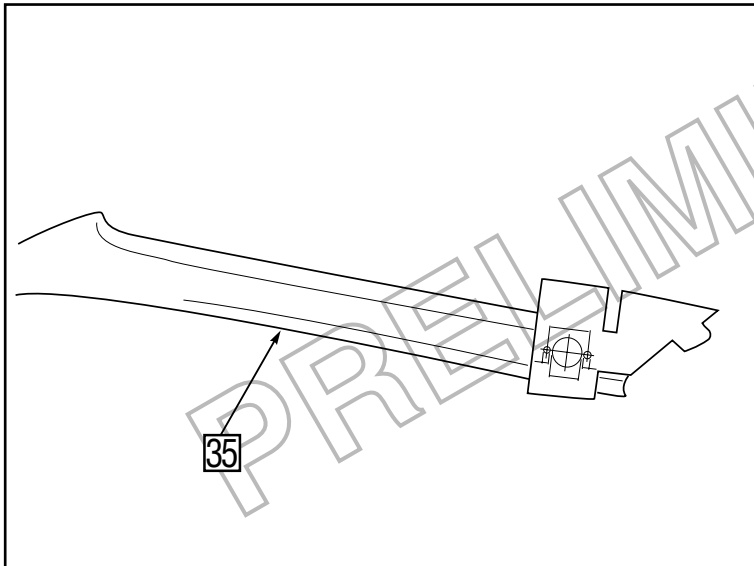

Fig. 67

8.
 - a) Cut out the "Avensis" template and put it on the A-pillar cover **35**.
 - b) Drill 2 holes of 7 mm.
 - c) Drill a hole of 32 mm.

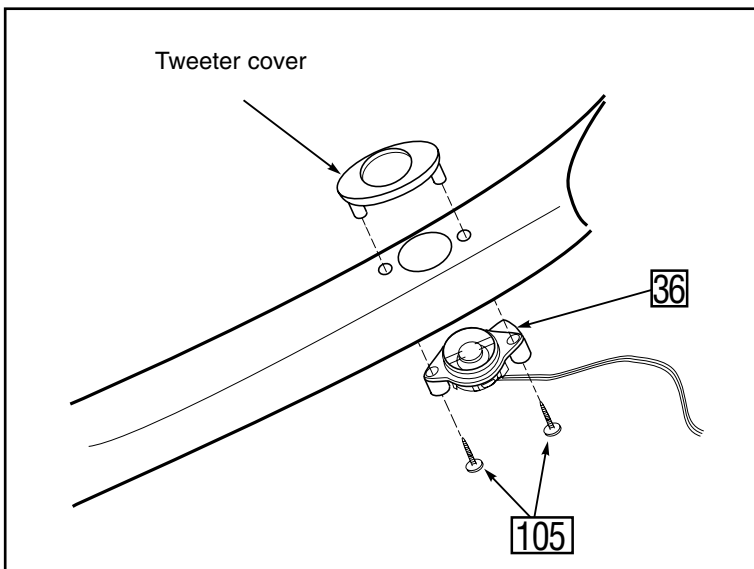

Fig. 68

9. Fit the tweeter **36** on the A-pillar cover **35**. Mount the A-pillar cover **35** on the vehicle.
105: Bolt (2x)

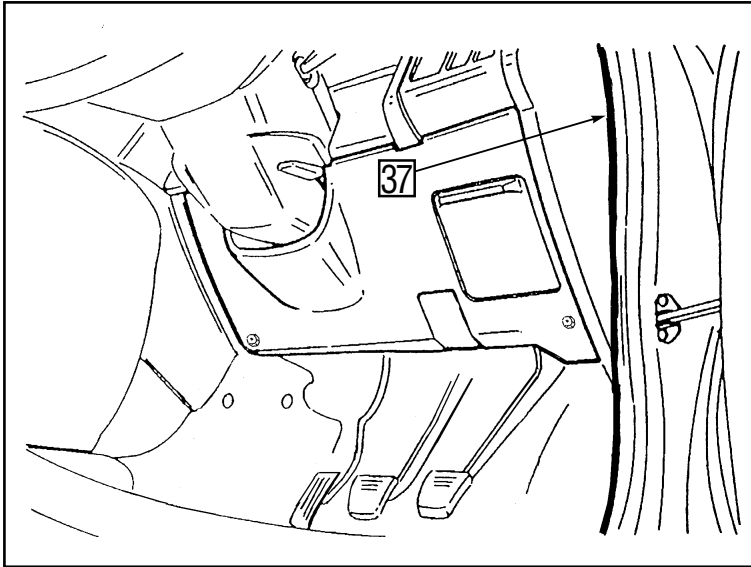

Fig. 69

10. Guide the tweeter wire 37 to the cowl side area.

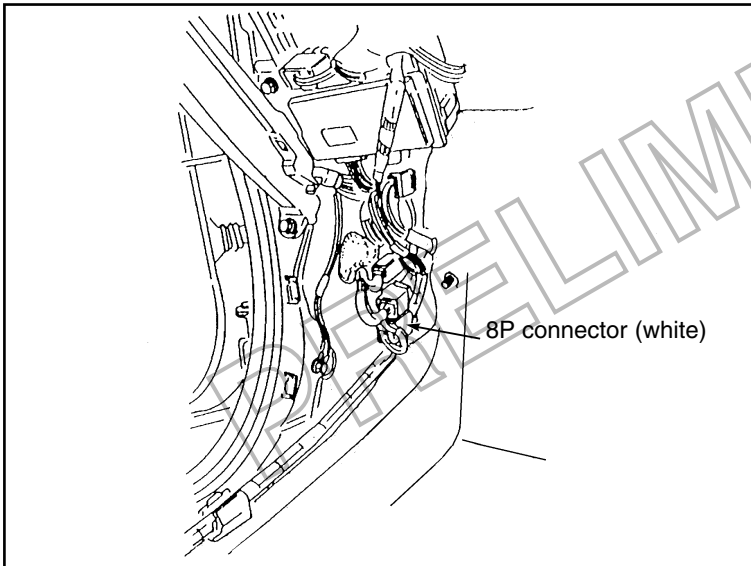

Fig. 70

LEFT HAND SIDE

11. Locate and disconnect the 8P connector (white).

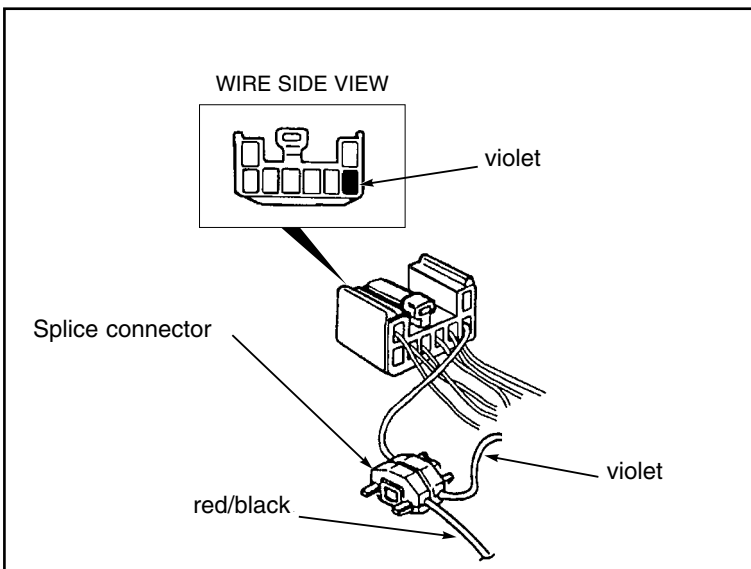

Fig. 71

12.
 - a) Turn the connector so that the wires face you.
 - b) Connect the red/black wire of the tweeter to the violet wire of the first position from the right side of the lowest row.

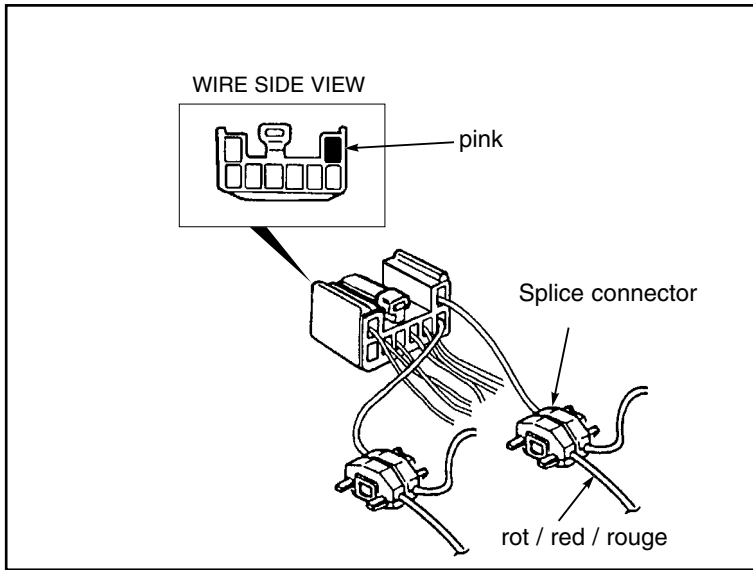

Fig. 72

13. Connect the red wire of the tweeter to the pink wire of the wire harness.

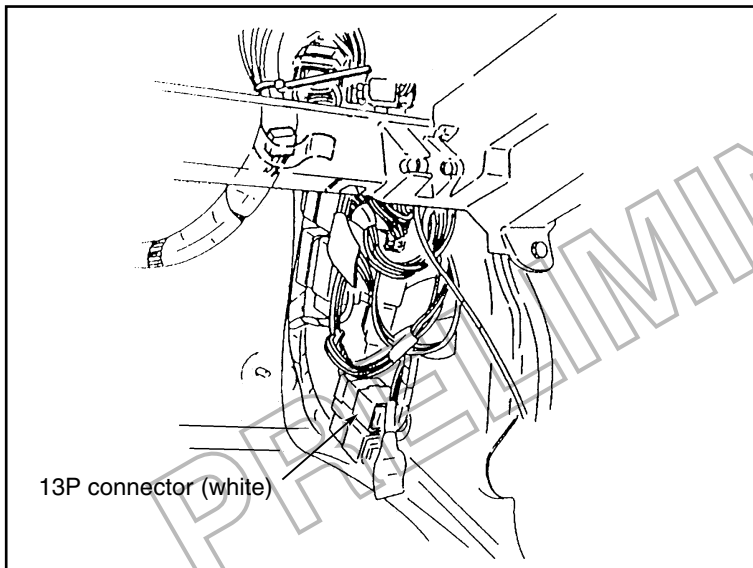

Fig. 73

RIGHT HAND SIDE

14. Locate and disconnect the 13P white connector at the cowl side area.

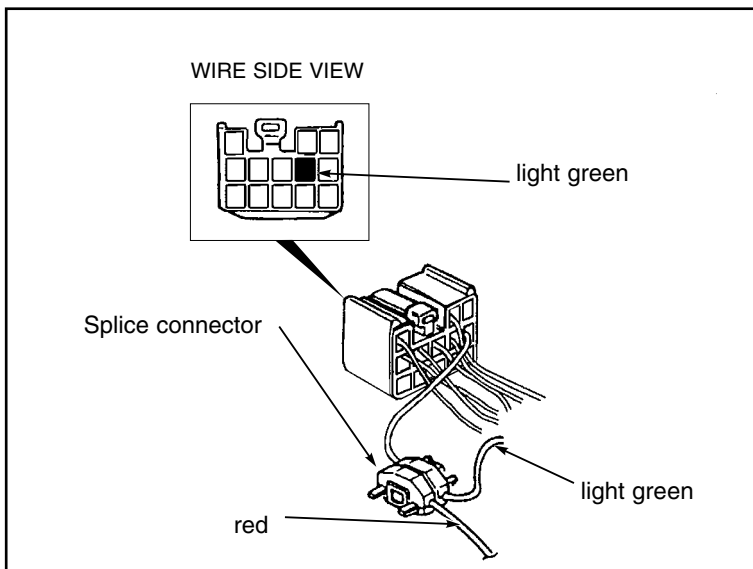

Fig. 74

15.
 - a) Turn the 13P connector so that the wires face you and the tab is on top.
 - b) Connect the red/black wire of the tweeter to the light green wire of the wire harness.

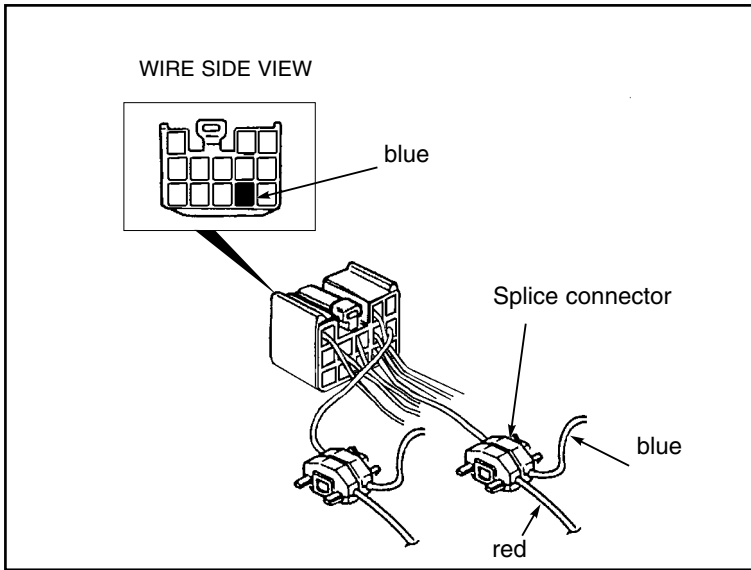

Fig. 75

16. Connect the red wire of the tweeter to the blue wire of the wire harness.

PRELIMINARY

NOTES



PRELIMINARY

PRELIMINARY

TOYOTA
GENUINE PARTS