

Toyota Tilt Sensor System



TOYOTA

ALWAYS A
BETTER WAY

Owner's manual

Revision record

Rev. No.	Date	Page	Picture	Update	New	Deleted steps



Read this manual thoroughly before using the Tilt Sensor System.
Always keep this owner's manual in the vehicle.

1. Introduction:

The vehicle is equipped with an inclination alarm which will trigger an acoustic alarm when the vehicle is jacked or lifted off the ground.

2. Activation of the system:

Rotate the ignition key from ON to OFF position or push start/stop to switch OFF.

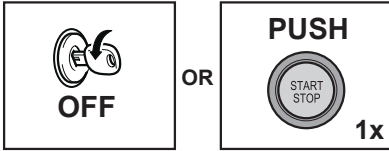

The LED lights up for 30 seconds continuously and then starts flashing indicating that the system is engaged.

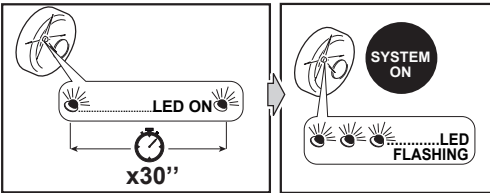

3. Deactivation of the system:

Rotate the ignition key from OFF to ON position or push start/stop to switch ON.

The LED turns off.

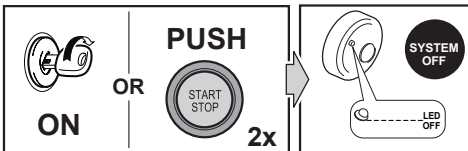

4. Alarm trigger:

If the vehicle is jacked or lifted, the system triggers and the vehicle horn sounds for 30 seconds together with the (optional) siren.

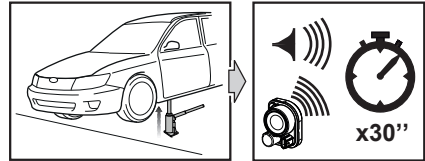

After 30 seconds the acoustic alarm switches OFF.

5. Notification lifting attempt:

If the system has been triggered because of a lifting attempt, when ignition is switched ON by ignition key or start/stop button, the LED lights up flashing for continuous cycles of 10 flashes and the siren emits 4 beeps.

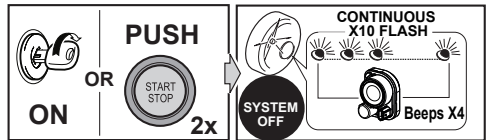

6. Deactivation during alarm phase:

There are two ways to stop the alarm once it is triggered.

6.1 Switch "ON" ignition:

Rotate the key to ON or push start/stop button to switch ON, the vehicle horn and (optional) siren will stop.

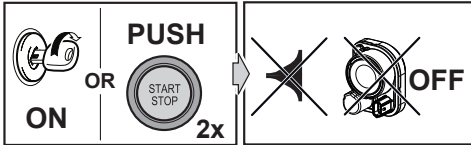

6.2 Enter PIN CODE:

The PIN CODE is indicated on the PIN CODE CARD supplied with the system. Work as shown in the below illustrations to enter the PIN CODE. After the PIN CODE is entered the vehicle horn and (optional) siren will stop.

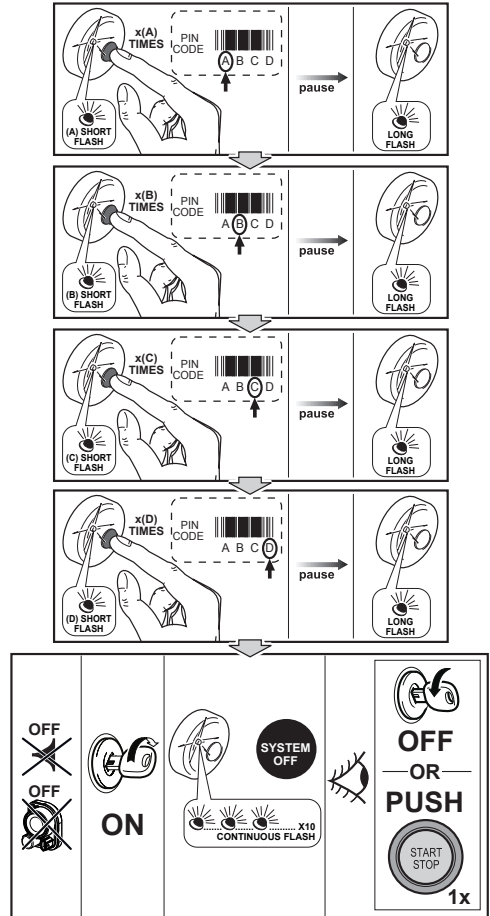

7. System deactivation

The system can be deactivated once by “Temporary Exclusion Procedure” or permanently by “Permanent Exclusion Procedure”.

Temporary Exclusion (once)

Rotate the ignition key from ON to OFF position or push start/stop button to switch OFF.

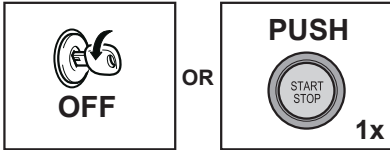

Within 30 seconds from the key positioning to OFF position with continuously lit up LED, press the button and keep it pressed until the LED switches off. The system is deactivated once.

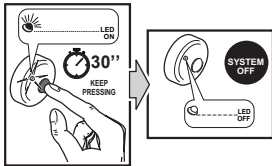

To restore the system, rotate the key to ON position or push start/stop button to switch ON. Then, rotate the ignition key to OFF position or push start/stop button to switch OFF, the system re-activates.

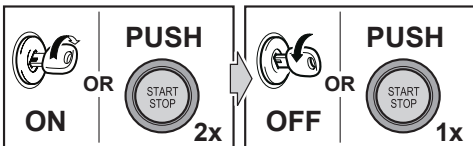

Permanent Exclusion (Garage Mode)

Rotate the ignition key from OFF to ON position or push start/stop button to switch ON.

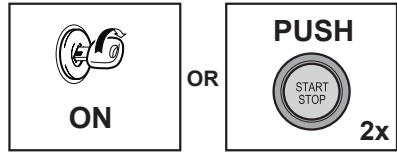

Within 10 seconds from the key positioning to ON position, press the button and keep it pressed until the LED lights up flashing 5 times, then release the button; the LED is OFF and the system is permanently deactivated.

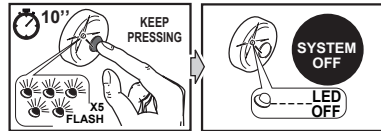

When the system is deactivated, it is possible to switch the car ON/OFF and perform any operation on the vehicle without triggering the acoustic alarm and the (optional) siren.

To reactivate the system, rotate the key to ON position or push start/stop button to switch ON.

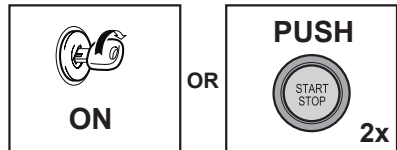

Press the button and keep it pressed until the LED lights up flashing 5 times, then release the button: the LED is OFF and the system is operational again. Rotate the ignition key from ON to OFF position or push start/stop button to switch OFF, the system reactivates.

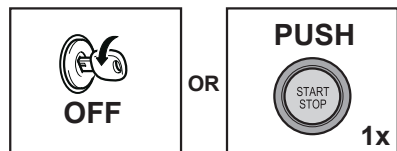

7. Warning



**During vehicle maintenance phases, exclude the system temporarily or permanently.
NEVER perform maintenance operations if the ignition key is in ON position.**

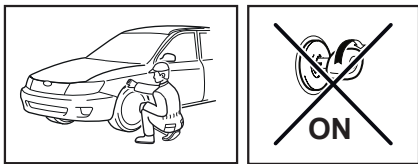



TOYOTA